

NOTES:

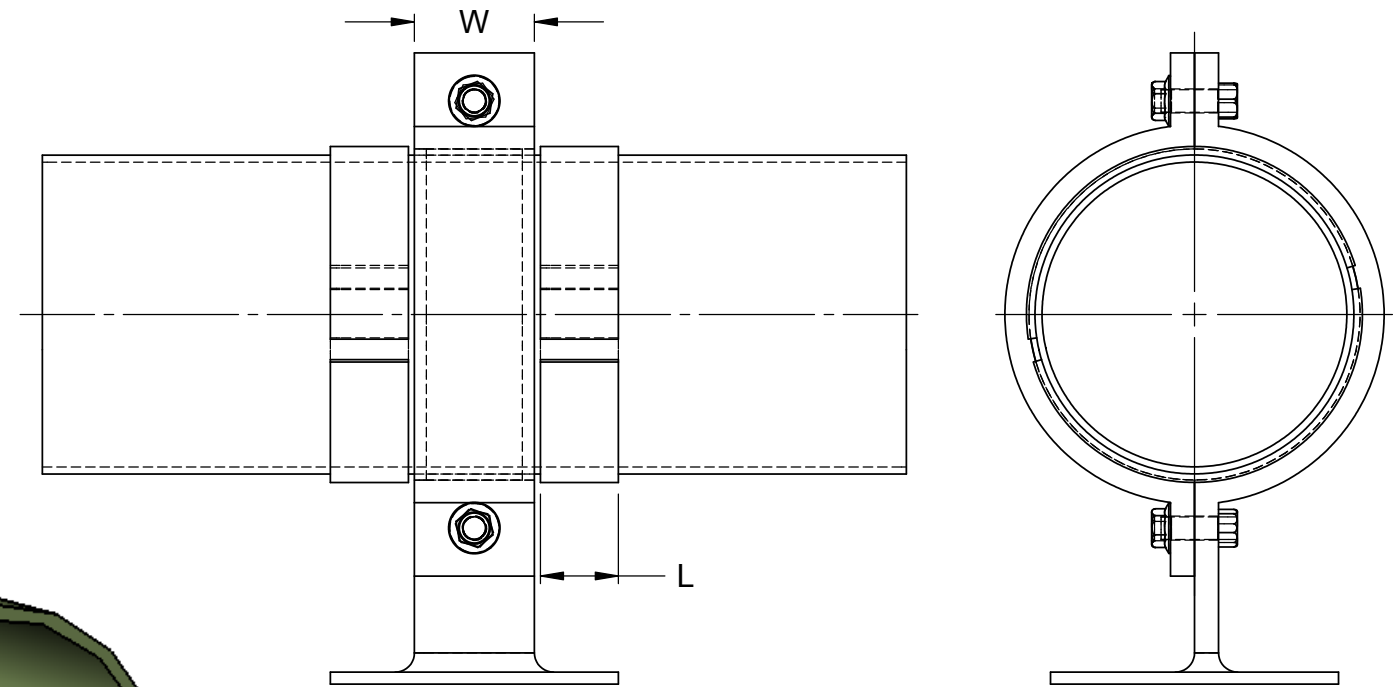
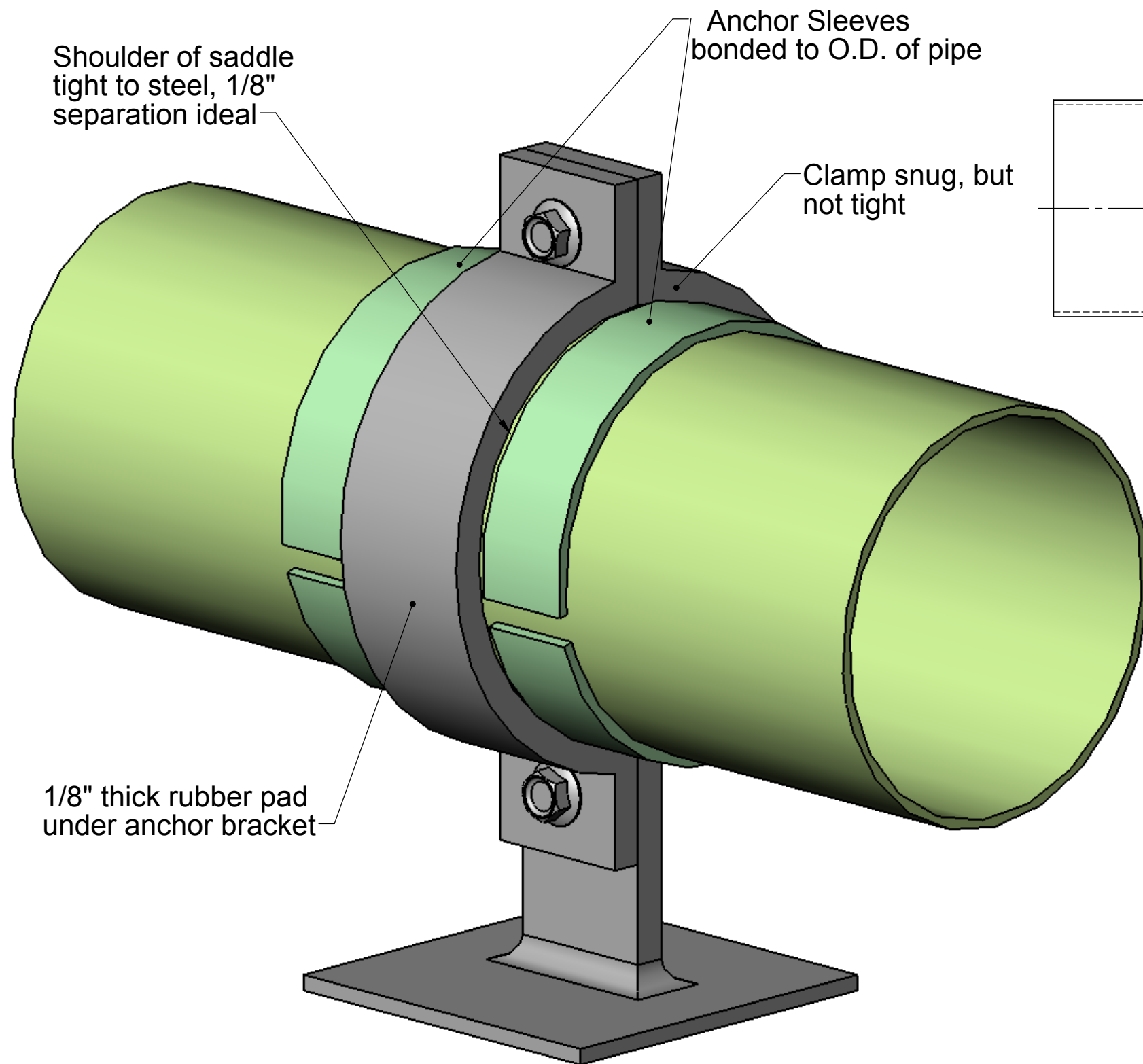

**Pipe Anchors: Anchor Steel & FRP Anchor Saddle Minimum Widths**

Pipe Size (in)	CL-2030, RB-2530, Chem Thread, Z-Core		Red Thread II, Green Thread, Silver Streak, F-Chem, CL-1520, RB-1520	
	Minimum Steel Width (W)	Anchor Saddle Width (min.) (180° x 2) (L)	Minimum Steel Width (W)	Anchor Saddle Width (min.) (180° x 2) (L)
1"	7/8"	1"	7/8"	1 1/2"
1 1/2"	7/8"	1 1/2"	7/8"	1 1/2"
2"	7/8"	2"	7/8"	2"
3"	1 1/4"	3"	1 1/4"	2"
4"	1 1/4"	4"	1 1/4"	4"
6"	1 1/2"	6"	1 1/2"	4"
8"	1 3/4"	6"	1 7/8"	4"
10"	1 3/4"	6"	2 5/8"	4"
12"	2"	6"	3 1/4"	4"
14"	2"	6"	4"	4"
16"	-	-	4"	4"
18"	-	-	4"	8"
20"	-	-	4"	8"
24"	-	-	4"	8"

\* Anchor saddles should be bonded with DS 3033 adhesive (P/N 46990-060-0) or Weldfast ZC 275 (P/N 390927-020-1) for maximum shear strength.

\* A thin layer of elastomer should be placed between the steel bracket and the pipe.

\* A fiberglass collar can also be laminated in place in lieu of the anchor saddles.

**Eastern Canada** #1 - 125 Main Street Woodstock, Ontario N4S 1T1  
**Western Canada** #100, 18012 - 105 Avenue Edmonton, Alberta T5S 2P1  
 Toll Free: (800) 410-4802  
 Fax: (519) 537-8321  
 frp@frpsolutions.com

**Fibreglass Solutions Inc.**

**Pipe Anchor**

**FRP-A-1**

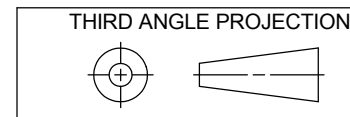

CUSTOMER: X  
 PROJECT: Supports, Anchors and Guide Design  
 DRAWN BY: J. GANDER DATE: 19 Jan 06  
 CHECKED BY: B.GOWLAND DATE: 28 Feb 06  
 APPROVED BY: B.GOWLAND DATE: 18 Apr 06

TITLE: Pipe Anchor  
 SIZE: DRAWING NO: -  
 SCALE: Not to Scale WEIGHT: N/A lbs  
 SHEET 1 OF 1