

EPOXY FITTINGS DIMENSIONS

2"-16" GREEN THREAD® fittings may be used with GREEN THREAD and RED THREAD® II piping. Refer to "Chemical Resistance Guide," Bulletin No. E5615, for chemical recommendations.

2"-16" RED THREAD II fittings may be used on RED THREAD II piping.

1"-1½" fittings are available in GREEN THREAD products only.

90° ELBOWS⁽¹⁾ 1" and 16" parts are available in GREEN Thread only.

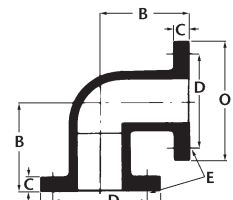
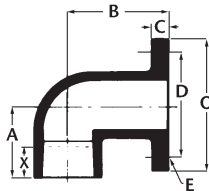
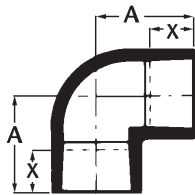

| Nom. Pipe Size | A | B | C | D | E | O | X ⁽²⁾ W/GT Pipe | X ⁽²⁾ W/RT II Pipe | Nominal Wgt BxB | Nominal Wgt BxF | Nominal Wgt FxF | Cyclic/Steady Pressure |
|----------------|------|-----|-----|------|-----------------|------|----------------------------|-------------------------------|-----------------|-----------------|-----------------|------------------------|
| In. | In. | In. | In. | In. | In. | In. | In. | In. | Lbs | Lbs | Lbs | psig |
| 1 | 2 ¾ | 3 ½ | ¾ | 3 ⅝ | ⅝D - 4 holes | 4 ¼ | 1 | - | 0.4 | 1.0 | 1.7 | 300/450 |
| 1 ½ | 3 ⅝ | 4 | ¾ | 3 ⅝ | ⅝D - 4 holes | 5 | 1 ⅜ | - | 0.6 | 1.5 | 2.4 | 300/450 |
| 2 | 3 ⅝ | 4 ½ | ¾ | 4 ¾ | ¾D - 4 holes | 6 | 1 ⅝ | 1 ⅜ | 1.2 | 2.5 | 3.6 | 300/450 |
| 3 | 4 ⅝ | 5 ½ | 1 ⅜ | 6 | ¾D - 4 holes | 7 ½ | 2 ⅝ | 1 ⅝ | 2.3 | 4.6 | 10.0 | 300/450 |
| 4 | 5 ⅝ | 6 ½ | 1 ⅝ | 7 ½ | ¾D - 8 holes | 9 | 2 | 1 ½ | 3.3 | 6.4 | 15.9 | 150/225 |
| 6 | 6 ⅝ | 8 | 1 ½ | 9 ½ | ⅞D - 8 holes | 11 | 2 ⅞ | 2 ⅜ | 7.2 | 11.8 | 15.9 | 150/225 |
| 8 | 11 ⅝ | 9 | 1 ¾ | 11 ¾ | ⅞D - 8 holes | 13 ½ | 3 ⅜ | 4 ⅜ | 10.9 | 15.4 | 19.9 | 150/225 |
| 10 | 13 ⅝ | 11 | 2 | 14 ¼ | 1D - 12 holes | 16 | 3 ⅞ | 4 ⅝ | 14.9 | 23.8 | 32.8 | 150/225 |
| 12 | 14 | 12 | 2 ¼ | 17 | 1D - 12 holes | 19 | 4 | 4 ¼ | 22.6 | 38.3 | 54.0 | 150/225 |
| 14 | 19 | 14 | 2 ½ | 18 ¾ | 1 ⅛D - 12 holes | 20 ¾ | 3 ⅝ | 3 ⅝ | 26.5 | 45.0 | 65.0 | 150/225 |
| 16 | 20 ¼ | 15 | 2 ½ | 21 ¼ | 1 ⅛D - 16 holes | 23 ¼ | 3 ⅝ | 3 ⅝ | 45.0 | 65.0 | 108.0 | 150/225 |

| mm | mm | mm | mm | mm | mm | mm | mm | mm | mm | kg | kg | kg | MPa |
|-----|-----|-----|----|-----|----------------|-----|-----|-----|-------|-------|-------|-----------|-----|
| 25 | 70 | 89 | 19 | 79 | 16D - 4 holes | 108 | 25 | - | 0.18 | 0.45 | 0.77 | 2.07/3.10 | |
| 38 | 86 | 102 | 19 | 98 | 16D - 4 holes | 127 | 35 | - | 0.27 | 0.68 | 1.09 | 2.07/3.10 | |
| 51 | 86 | 114 | 19 | 121 | 19D - 4 holes | 152 | 41 | 35 | 0.54 | 1.13 | 1.63 | 2.07/3.10 | |
| 76 | 117 | 140 | 35 | 152 | 19D - 4 holes | 190 | 54 | 41 | 1.04 | 2.09 | 4.54 | 2.07/3.10 | |
| 102 | 130 | 165 | 35 | 190 | 19D - 8 holes | 229 | 51 | 38 | 1.50 | 2.90 | 7.21 | 1.03/1.55 | |
| 152 | 156 | 203 | 38 | 241 | 22D - 8 holes | 279 | 73 | 60 | 3.27 | 5.35 | 7.21 | 1.03/1.55 | |
| 203 | 295 | 229 | 44 | 298 | 22D - 8 holes | 343 | 86 | 111 | 4.94 | 6.99 | 9.02 | 1.03/1.55 | |
| 254 | 333 | 279 | 51 | 362 | 25D - 12 holes | 406 | 98 | 104 | 6.76 | 10.80 | 14.88 | 1.03/1.55 | |
| 305 | 356 | 305 | 57 | 432 | 25D - 12 holes | 483 | 102 | 108 | 10.25 | 17.37 | 24.49 | 1.03/1.55 | |
| 356 | 483 | 356 | 64 | 476 | 29D - 12 holes | 527 | 92 | 92 | 12.02 | 20.41 | 29.48 | 1.03/1.55 | |
| 406 | 514 | 381 | 64 | 540 | 29D - 16 holes | 591 | 92 | 92 | 20.41 | 29.48 | 48.99 | 1.03/1.55 | |

(1) "A" dimensions shown are for GREEN THREAD fittings. 1"-6" fittings are compression molded; 8"-16" fittings are filament wound.

(2) This is a nominal make-up dimension for drawing layout work only. Do not use for assembly dimensions.

(3) Flanges should be joined only to flat-faced flanges. See Smith Fibercast Manual No. E5000 for valve, bolt and gasket recommendations.

GT = GREEN THREAD RT II - RED THREAD II

45° ELBOWS⁽¹⁾ 1"-16" parts are available in GREEN THREAD only.

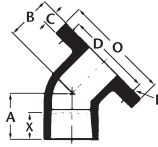
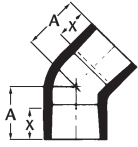

| Nom. Pipe Size | A | B | C | D | E | O | X ⁽²⁾ W/GT Pipe | X ⁽²⁾ W/RT II Pipe | Nom. Weight BxB | Nom. Weight BxF | Nom. Weight FxF | Cyclic/ Steady Pressure |
|-------------------------------|--------------------------------|-------------------------------|-------------------------------|--------------------------------|-----------------|--------------------------------|-------------------------------|-------------------------------|-----------------|-----------------|-----------------|-------------------------|
| In. | In. | In. | In. | In. | In. | In. | In. | In. | Lbs. | Lbs. | Lbs. | psig |
| 1 | 2 ³ / ₈ | 2 | 3/4 | 3 ¹ / ₈ | 5/8D-4 holes | 4 ¹ / ₄ | 1 | - | .3 | .8 | 1.4 | 300/450 |
| 1 ¹ / ₂ | 2 ⁷ / ₈ | 2 ¹ / ₄ | 3/4 | 3 ⁷ / ₈ | 5/8D-4 holes | 5 | 1 ¹ / ₈ | - | .4 | 1.2 | 2.0 | 300/450 |
| 2 | 2 ⁵ / ₈ | 2 ¹ / ₂ | 3/4 | 4 ³ / ₄ | 3/4D-4 holes | 6 | 1 ¹ / ₈ | 1 ¹ / ₈ | .9 | 1.9 | 2.8 | 300/450 |
| 3 | 3 ³ / ₄ | 3 | 1 ¹ / ₈ | 6 | 3/4D-4 holes | 7 ¹ / ₂ | 2 ¹ / ₈ | 1 ¹ / ₈ | 1.6 | 3.5 | 7.9 | 300/450 |
| 4 | 3 ⁷ / ₈ | 4 | 1 ¹ / ₈ | 7 ¹ / ₂ | 3/4D-8 holes | 9 | 2 | 1 ¹ / ₂ | 2.4 | 5.1 | 13.1 | 150/225 |
| 6 | 4 ³ / ₈ | 5 | 1 ¹ / ₂ | 9 ¹ / ₂ | 7/8D-8 holes | 11 | 2 ⁷ / ₈ | 2 ³ / ₈ | 4.8 | 8.4 | 12.5 | 150/225 |
| 8 | 8 ¹ / ₈ | 5 ¹ / ₂ | 1 ³ / ₄ | 11 ³ / ₄ | 7/8D-8 holes | 13 ¹ / ₂ | 3 ³ / ₈ | 4 ³ / ₈ | 6.9 | 11.9 | 16.8 | 150/225 |
| 10 | 8 ⁵ / ₈ | 6 ¹ / ₂ | 2 | 14 ¹ / ₄ | 1D-12 holes | 16 | 3 ⁷ / ₈ | 4 ¹ / ₈ | 8.9 | 18.5 | 28.2 | 150/225 |
| 12 | 9 ¹ / ₂ | 7 ¹ / ₂ | 2 ¹ / ₄ | 17 | 1D-12 holes | 19 | 4 | 4 ¹ / ₄ | 14.0 | 32.6 | 47.2 | 150/225 |
| 14 | 12 ¹ / ₂ | 7 ¹ / ₂ | 2 ¹ / ₂ | 18 ³ / ₄ | 1 1/8D-12 holes | 20 ³ / ₄ | 3 ⁵ / ₈ | 3 ⁵ / ₈ | 17.0 | 46.0 | 73.0 | 150/225 |
| 16 | 13 ³ / ₄ | 8 | 2 ¹ / ₂ | 21 ¹ / ₄ | 1 1/8D-16 holes | 23 ¹ / ₄ | 3 ⁵ / ₈ | 3 ⁵ / ₈ | 25.0 | 56.0 | 84.0 | 150/225 |
| mm | mm | mm | mm | mm | mm | mm | mm | mm | kg | kg | kg | MPa |
| 25 | 60 | 51 | 19 | 79 | 16D-4 holes | 108 | 25 | - | .14 | 0.36 | 0.64 | 2.07/3.10 |
| 38 | 73 | 57 | 19 | 98 | 16D-4 holes | 127 | 35 | - | .18 | 0.54 | 0.91 | 2.07/3.10 |
| 51 | 67 | 64 | 19 | 121 | 19D-4 holes | 152 | 41 | 35 | .41 | 0.86 | 1.27 | 2.07/3.10 |
| 76 | 95 | 76 | 35 | 152 | 19D-4 holes | 190 | 54 | 41 | .73 | 1.59 | 3.58 | 2.07/3.10 |
| 102 | 98 | 102 | 35 | 190 | 19D-8 holes | 229 | 51 | 38 | 1.09 | 2.31 | 5.94 | 1.03/1.55 |
| 152 | 111 | 127 | 38 | 241 | 22D-8 holes | 279 | 73 | 60 | 2.18 | 3.81 | 5.67 | 1.03/1.55 |
| 203 | 206 | 140 | 44 | 298 | 22D-8 holes | 343 | 86 | 111 | 3.11 | 5.40 | 7.62 | 1.03/1.55 |
| 254 | 219 | 165 | 51 | 362 | 25D-12 holes | 406 | 98 | 105 | 4.04 | 8.39 | 12.79 | 1.03/1.55 |
| 305 | 241 | 190 | 57 | 432 | 25D- 12 holes | 483 | 102 | 108 | 6.35 | 14.78 | 21.41 | 1.03/1.55 |
| 356 | 318 | 191 | 64 | 476 | 29D-12 holes | 527 | 92 | 92 | 7.71 | 20.87 | 33.11 | 1.03/1.55 |
| 406 | 337 | 203 | 64 | 540 | 29D-16 holes | 591 | 92 | 92 | 11.3 | 25.40 | 38.10 | 1.03/1.55 |

TEES(1) 1"-16" parts are available in GREEN THREAD only.

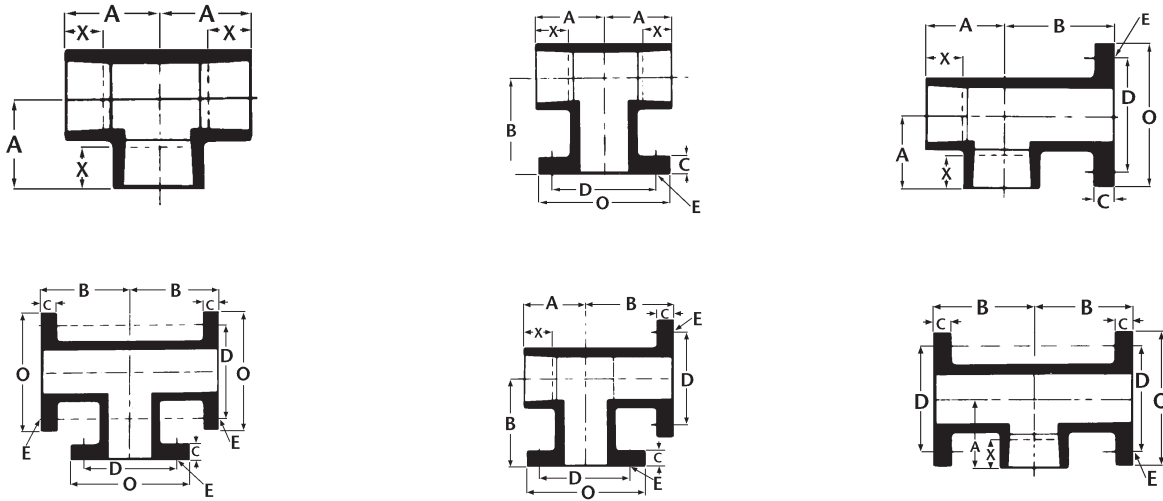

| Nom. Pipe Size | A | B | C | D | E | O | X(2) W/GT Pipe | X(2) W/RT II Pipe | Nom. Wgt 3B | Nom. Wgt 1F | Nom. Wgt 2F | Nom. Wgt 3F | Cyclic/ Steady Pressure |
|----------------|-----|-----|-----|-----|-----------------|-----|----------------|-------------------|-------------|-------------|-------------|-------------|-------------------------|
| In. | In. | In. | In. | In. | In. | In. | In. | In. | Lbs. | Lbs. | Lbs. | Lbs. | psig |
| 1 | 2¾ | 3½ | ¾ | 3⅞ | ⅝D - 4 holes | 4¼ | 1 | - | .5 | 1.1 | 1.8 | 2.5 | 300/450 |
| 1 ½ | 3⅝ | 4 | ¾ | 3⅞ | ⅝D - 4 holes | 5 | 1⅝ | - | .9 | 1.9 | 2.8 | 3.6 | 300/450 |
| 2 | 3⅝ | 4½ | ¾ | 4¾ | ¾D - 4 holes | 6 | 1⅝ | 1⅝ | 1.9 | 3.1 | 4.8 | 5.5 | 300/450 |
| 3 | 4 | 5 | 1⅝ | 6 | ¾D - 4 holes | 7½ | 2⅝ | 1⅝ | 3.6 | 5.8 | 8.0 | 14.5 | 300/450 |
| 4 | 5⅝ | 6½ | 1⅝ | 7½ | ¾D - 8 holes | 9 | 2 | 1½ | 4.9 | 8.0 | 11.3 | 22.7 | 150/225 |
| 6 | 6⅞ | 8 | 1½ | 9½ | ⅞D - 8 holes | 11 | 2⅝ | 2⅝ | 10.1 | 14.3 | 19.0 | 22.3 | 150/225 |
| 8 | 11⅝ | 9 | 1¾ | 11¾ | ⅞D - 8 holes | 13½ | 3⅝ | 4⅝ | 16.1 | 20.4 | 24.6 | 28.9 | 150/225 |
| 10 | 13 | 11 | 2 | 14¼ | 1D - 12 holes | 16 | 3⅝ | 4⅝ | 26.2 | 34.1 | 42.0 | 49.8 | 150/225 |
| 12 | 14 | 12 | 2¼ | 17 | 1D - 12 holes | 19 | 4 | 4¼ | 31.8 | 47.1 | 62.5 | 77.8 | 150/225 |
| 14 | 19 | 14 | 2½ | 18¾ | 1 ⅛D - 12 holes | 20¾ | 3⅝ | 3⅝ | 52.0 | 75.5 | 99.5 | 127.0 | 150/225 |
| 16 | 20¼ | 15 | 2½ | 21¼ | 1 ⅛D - 16 holes | 23¼ | 3⅝ | 3⅝ | 68.0 | 107.0 | 135.0 | 170.0 | 150/225 |

| mm | mm | mm | mm | mm | mm | mm | mm | mm | kg | kg | kg | kg | MPa |
|-----|-----|-----|----|-----|--------------|-----|-----|-----|------|------|------|------|-----------|
| 25 | 70 | 89 | 19 | 79 | 16D-4 holes | 108 | 25 | - | 0.2 | 0.5 | 0.8 | 1.1 | 2.07/3.10 |
| 38 | 86 | 102 | 19 | 98 | 16D-4 holes | 127 | 35 | - | 0.4 | 0.9 | 1.3 | 1.6 | 2.07/3.10 |
| 51 | 86 | 114 | 19 | 121 | 19D-4 holes | 152 | 41 | 35 | 0.9 | 1.4 | 2.2 | 2.5 | 2.07/3.10 |
| 76 | 102 | 127 | 35 | 152 | 19D-4 holes | 190 | 54 | 41 | 1.6 | 2.6 | 3.6 | 6.6 | 2.07/3.10 |
| 102 | 130 | 165 | 35 | 190 | 19D-8 holes | 229 | 51 | 38 | 2.2 | 3.6 | 5.1 | 10.3 | 1.03/1.55 |
| 152 | 156 | 203 | 38 | 241 | 22D-8 holes | 279 | 73 | 60 | 4.6 | 6.5 | 8.6 | 10.1 | 1.03/1.55 |
| 203 | 295 | 229 | 44 | 298 | 22D-8 holes | 343 | 86 | 111 | 7.3 | 9.3 | 11.2 | 13.1 | 1.03/1.55 |
| 254 | 330 | 279 | 51 | 362 | 25D-12 holes | 406 | 98 | 105 | 11.9 | 15.5 | 19.1 | 22.6 | 1.03/1.55 |
| 305 | 356 | 305 | 57 | 432 | 25D-12 holes | 483 | 102 | 108 | 14.4 | 21.4 | 28.3 | 35.3 | 1.03/1.55 |
| 356 | 483 | 356 | 64 | 476 | 29D-12 holes | 527 | 92 | 92 | 23.6 | 34.2 | 45.1 | 57.6 | 1.03/1.55 |
| 406 | 514 | 381 | 64 | 540 | 29D-16 holes | 591 | 92 | 92 | 30.8 | 48.5 | 61.2 | 77.1 | 1.03/1.55 |

REDUCING TEES

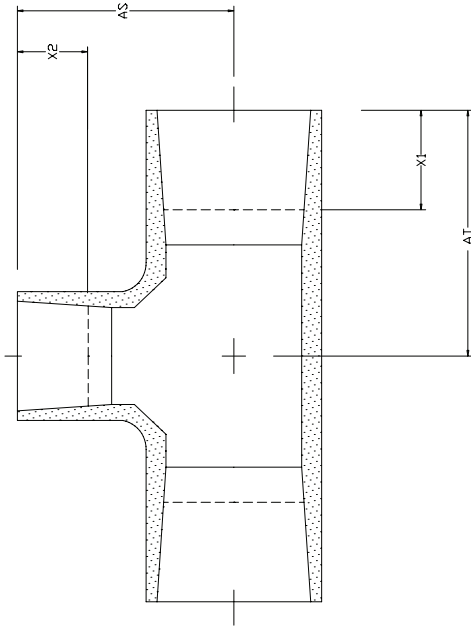

| Nom. Size | AT | | X ₁ W/GT Pipe ⁽¹⁾ | | X ₁ W/RTII Pipe ⁽¹⁾ | | AS | X ₂ W/GT Pipe ⁽¹⁾ | | X ₂ W/RTII Pipe ⁽¹⁾ | | Nom. Wgt. | Steady Pressure | Nom. Size | AT | X ₁ W/GT Pipe ⁽¹⁾ | X ₁ W/RTII Pipe ⁽¹⁾ | AS | X ₂ W/GT Pipe ⁽¹⁾ | X ₂ W/RTII Pipe ⁽¹⁾ | Nom. Wgt. | Steady Pressure |
|-----------|----------------------------------|-----|---|-----|---|-----|----------------------------------|---|-----|---|-----|-----------|-----------------|-----------|-----|---|---|-----|---|---|-----------|-----------------|
| | In. | mm | In. | mm | In. | mm | | In. | mm | In. | mm | | | | | | | | | | | |
| 8x6 | 11 ⁵ / ₈ | 295 | 3 ⁵ / ₈ | 92 | 4 ¹ / ₂ | 114 | 10 ¹ / ₄ | 2 ⁷ / ₈ | 73 | 260 | 60 | 10.4 | 1.55 | 203x152 | 295 | 92 | 114 | 260 | 73 | 60 | 10.4 | 1.55 |
| 8x4 | 11 ⁵ / ₈ | 295 | 3 ⁵ / ₈ | 92 | 4 ¹ / ₂ | 114 | 10 ¹ / ₄ | 2 | 51 | 260 | 38 | 9.5 | 1.55 | 203x102 | 295 | 92 | 114 | 260 | 51 | 38 | 9.5 | 1.55 |
| 8x3 | 11 ⁵ / ₈ | 295 | 3 ⁵ / ₈ | 92 | 4 ¹ / ₂ | 114 | 9 ⁷ / ₈ | 2 ¹ / ₈ | 54 | 251 | 41 | 9.1 | 1.55 | 203x76 | 295 | 92 | 114 | 251 | 54 | 41 | 9.1 | 1.55 |
| 8x2 | 11 ⁵ / ₈ | 295 | 3 ⁵ / ₈ | 92 | 4 ¹ / ₂ | 114 | 9 ¹³ / ₁₆ | 1 ⁵ / ₈ | 41 | 249 | 35 | 8.6 | 1.55 | 203x51 | 295 | 92 | 114 | 249 | 41 | 35 | 8.6 | 1.55 |
| 10x8 | 13 ¹ / ₁₆ | 332 | 3 ⁷ / ₈ | 98 | 4 ¹ / ₈ | 105 | 13 ⁵ / ₈ | 3 ⁵ / ₈ | 92 | 346 | 92 | 17.7 | 1.55 | 254x203 | 332 | 98 | 105 | 346 | 92 | 114 | 17.7 | 1.55 |
| 10x6 | 13 ¹ / ₁₆ | 332 | 3 ⁷ / ₈ | 98 | 4 ¹ / ₈ | 105 | 11 ³ / ₄ | 2 ⁷ / ₈ | 98 | 298 | 60 | 16.3 | 1.55 | 254x152 | 332 | 98 | 105 | 298 | 73 | 60 | 16.3 | 1.55 |
| 10x4 | 13 ¹ / ₁₆ | 332 | 3 ⁷ / ₈ | 98 | 4 ¹ / ₈ | 105 | 11 ³ / ₄ | 2 | 51 | 298 | 38 | 14.9 | 1.55 | 254x102 | 332 | 98 | 105 | 298 | 51 | 38 | 14.9 | 1.55 |
| 10x3 | 13 ¹ / ₁₆ | 332 | 3 ⁷ / ₈ | 98 | 4 ¹ / ₈ | 105 | 11 ³ / ₄ | 2 ¹ / ₈ | 54 | 289 | 41 | 14.5 | 1.55 | 254x76 | 332 | 98 | 105 | 289 | 54 | 41 | 14.5 | 1.55 |
| 12x10 | 13 ¹⁵ / ₁₆ | 354 | 4 | 102 | 4 ³ / ₈ | 111 | 15 ¹ / ₁₆ | 3 ⁷ / ₈ | 98 | 383 | 105 | 23.1 | 1.55 | 305x254 | 354 | 102 | 111 | 383 | 98 | 105 | 23.1 | 1.55 |
| 12x8 | 13 ¹⁵ / ₁₆ | 354 | 4 | 102 | 4 ³ / ₈ | 111 | 15 ¹ / ₁₆ | 3 ⁵ / ₈ | 102 | 383 | 114 | 21.8 | 1.55 | 305x203 | 354 | 102 | 111 | 383 | 92 | 114 | 21.8 | 1.55 |
| 12x6 | 13 ¹⁵ / ₁₆ | 354 | 4 | 102 | 4 ³ / ₈ | 111 | 13 ³ / ₄ | 2 ⁷ / ₈ | 73 | 337 | 60 | 20.4 | 1.55 | 305x152 | 354 | 102 | 111 | 337 | 73 | 60 | 20.4 | 1.55 |
| 12x4 | 13 ¹⁵ / ₁₆ | 354 | 4 | 102 | 4 ³ / ₈ | 111 | 13 ³ / ₄ | 2 | 51 | 337 | 38 | 19.1 | 1.55 | 305x102 | 354 | 102 | 111 | 337 | 51 | 38 | 19.1 | 1.55 |
| 14x12 | 19 ¹ / ₁₆ | 484 | 6 ³ / ₈ | 162 | 6 ¹ / ₂ | 165 | 15 ¹⁵ / ₁₆ | 4 | 102 | 405 | 114 | 30.4 | 1.55 | 356x305 | 484 | 162 | 165 | 405 | 102 | 114 | 30.4 | 1.55 |
| 14x10 | 19 ¹ / ₁₆ | 484 | 6 ³ / ₈ | 162 | 6 ¹ / ₂ | 165 | 15 ⁹ / ₁₆ | 3 ⁷ / ₈ | 98 | 395 | 105 | 29.0 | 1.55 | 356x254 | 484 | 162 | 165 | 395 | 98 | 105 | 29.0 | 1.55 |
| 14x8 | 19 ¹ / ₁₆ | 484 | 6 ³ / ₈ | 162 | 6 ¹ / ₂ | 165 | 15 ⁵ / ₈ | 3 ⁵ / ₈ | 92 | 390 | 114 | 27.2 | 1.55 | 356x203 | 484 | 162 | 165 | 390 | 92 | 114 | 27.2 | 1.55 |
| 14x6 | 19 ¹ / ₁₆ | 484 | 6 ³ / ₈ | 162 | 6 ¹ / ₂ | 165 | 13 ³ / ₄ | 2 ⁷ / ₈ | 73 | 349 | 60 | 25.9 | 1.55 | 356x152 | 484 | 162 | 165 | 349 | 73 | 60 | 25.9 | 1.55 |
| 16x14 | 20 ¹ / ₄ | 514 | 6 ⁵ / ₈ | 168 | 6 ⁵ / ₈ | 168 | 19 ¹ / ₂ | 6 ³ / ₈ | 102 | 495 | 165 | 46.7 | 1.55 | 406x356 | 514 | 168 | 168 | 495 | 162 | 165 | 46.7 | 1.55 |
| 16x12 | 20 ¹ / ₄ | 514 | 6 ⁵ / ₈ | 168 | 6 ⁵ / ₈ | 168 | 16 ¹⁵ / ₁₆ | 4 | 102 | 430 | 114 | 44.9 | 1.55 | 406x305 | 514 | 168 | 168 | 430 | 102 | 114 | 44.9 | 1.55 |
| 16x10 | 20 ¹ / ₄ | 514 | 6 ⁵ / ₈ | 168 | 6 ⁵ / ₈ | 168 | 16 ⁵ / ₈ | 3 ⁷ / ₈ | 98 | 422 | 105 | 42.6 | 1.55 | 406x254 | 514 | 168 | 168 | 422 | 98 | 105 | 42.6 | 1.55 |
| 16x8 | 20 ¹ / ₄ | 514 | 6 ⁵ / ₈ | 168 | 6 ⁵ / ₈ | 168 | 16 ⁵ / ₈ | 3 ⁵ / ₈ | 92 | 422 | 114 | 40.8 | 1.55 | 406x203 | 514 | 168 | 168 | 422 | 92 | 114 | 40.8 | 1.55 |

ORIFICE FLANGES (2"-8" parts are available in GREEN THREAD only)

2" ORIFICE FLANGE

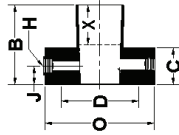

3"-8" ORIFICE FLANGE

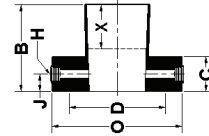

| Nom. Pipe Size | B | C | D | E | H | J | O | X ⁽¹⁾ W/ GT Pipe | X ⁽¹⁾ W/RTII Pipe | Recom. Torquing of Flanges ⁽²⁾ | | Nom. Wt. Lbs | Cyclic/Steady Pressure psig |
|----------------|----|---|-----|--------------|-------|---|-----|-----------------------------|------------------------------|---|------|--------------|-----------------------------|
| | | | | | | | | | | To Seal | Max. | | |
| 2 | 4¼ | 2 | 4¾ | ¾D - 4 holes | ½ NPT | 1 | 6 | 1⅝ | 1⅝ | 25 | 30 | 3.6 | 300/450 |
| 3 | 5 | 2 | 6 | ¾D - 4 holes | ½ NPT | 1 | 7½ | 2⅝ | 1⅝ | 25 | 30 | 5.3 | 300/450 |
| 4 | 5 | 2 | 7½ | ¾D - 8 holes | ½ NPT | 1 | 9 | 2 | 1½ | 25 | 30 | 6.6 | 150/225 |
| 6 | 6 | 2 | 9½ | ⅞D - 8 holes | ½ NPT | 1 | 11 | 2⅞ | 2⅞ | 25 | 30 | 8.8 | 150/225 |
| 8 | 8¾ | 2 | 11¾ | ⅞D - 8 holes | ½ NPT | 1 | 13½ | 3⅞ | 4⅞ | 30 | 100 | 14.5 | 150/225 |

| mm | mm | mm | mm | mm | mm | mm | mm | mm ⁽¹⁾ | mm ⁽¹⁾ | N-m ⁽²⁾ | N-m ⁽²⁾ | kg | MPa |
|-----|-----|----|-----|---------------|----------|----|-----|-------------------|-------------------|--------------------|--------------------|-----|-----------|
| 51 | 108 | 51 | 121 | 19D - 4 holes | 12.7 NPT | 25 | 152 | 41 | 35 | 34 | 41 | 1.6 | 2.07/3.10 |
| 76 | 127 | 51 | 152 | 19D - 4 holes | 12.7 NPT | 25 | 191 | 54 | 41 | 34 | 41 | 2.4 | 2.07/3.10 |
| 102 | 127 | 51 | 191 | 19D - 8 holes | 12.7 NPT | 25 | 229 | 51 | 38 | 34 | 41 | 3.0 | 1.03/1.55 |
| 152 | 152 | 51 | 241 | 22D - 8 holes | 12.7 NPT | 25 | 279 | 73 | 60 | 34 | 41 | 4.0 | 1.03/1355 |
| 203 | 222 | 51 | 298 | 22D - 8 holes | 12.7 NPT | 25 | 343 | 86 | 111 | 41 | 135 | 6.6 | 1.03/1.55 |

SLEEVE COUPLINGS

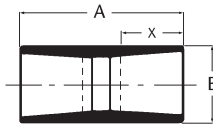

GREEN THREAD Product

| Nom. Pipe Size | A | B | X ⁽¹⁾ | Nominal Weight | Cyclic/Steady Pressure |
|----------------|-----|-----|------------------|----------------|------------------------|
| In. | In. | In. | In. | Lbs. | psig |
| 1 | 2¾ | 1½ | 1 | .1 | 300/450 |
| 1½ | 3¼ | 2 | 1⅝ | .1 | 300/450 |
| 2 | 4⅞ | 2⅝ | 1⅝ | .4 | 300/450 |
| 3 | 5 | 3¾ | 2⅝ | .8 | 300/450 |
| 4 | 5 | 4¾ | 2 | .9 | 150/225 |
| 6 | 7 | 6⅞ | 2⅞ | 1.9 | 150/225 |
| 8 | 10 | 9 | 2⅞ | 3.4 | 150/225 |
| 10 | 10½ | 11 | 3¼ | 5.2 | 150/225 |
| 12 | 11 | 13⅞ | 3⅝ | 7.5 | 150/225 |
| 14 | 12½ | 15 | 4⅝ | 11.2 | 150/225 |
| 16 | 13 | 17⅞ | 4½ | 16.0 | 150/225 |

| mm | mm | mm | mm ⁽¹⁾ | kg | MPa |
|-----|-----|-----|-------------------|------|-----------|
| 25 | 70 | 38 | 27 | 0.05 | 2.07/3.10 |
| 38 | 83 | 52 | 35 | 0.05 | 2.07/3.10 |
| 51 | 124 | 67 | 41 | 0.18 | 2.07/3.10 |
| 76 | 127 | 95 | 54 | 0.36 | 2.07/3.10 |
| 102 | 127 | 121 | 51 | 0.41 | 1.03/1.55 |
| 152 | 178 | 175 | 73 | 0.86 | 1.03/1.55 |
| 203 | 254 | 229 | 73 | 1.54 | 1.03/1.55 |
| 254 | 268 | 279 | 83 | 2.36 | 1.03/1.55 |
| 305 | 279 | 333 | 92 | 3.40 | 1.03/1.55 |
| 356 | 318 | 381 | 111 | 5.08 | 1.03/1.55 |
| 406 | 330 | 435 | 114 | 7.26 | 1.03/1.55 |

RED THREAD II Product

| Nom. Pipe Size | A | B | X ⁽¹⁾ | Nominal Weight | Cyclic/Steady Pressure |
|----------------|-----|-----|------------------|----------------|------------------------|
| In. | In. | In. | In. | Lbs. | psig |
| 1 | - | - | - | - | - |
| 1½ | - | - | - | - | - |
| 2 | 6 | 2⅝ | 2⅞ | .4 | 300/450 |
| 3 | 6 | 3¾ | 2⅞ | .8 | 300/450 |
| 4 | 7 | 4⅞ | 2⅞ | 1.4 | 300/450 |
| 6 | 8⅞ | 7⅞ | 3⅝ | 2.8 | 300/450 |
| 8 | 10 | 9 | 3⅞ | 3.3 | 150/225 |
| 10 | 10½ | 11⅞ | 3½ | 4.7 | 150/225 |
| 12 | 11 | 13⅞ | 3⅞ | 6.8 | 150/225 |
| 14 | 12½ | 15 | 4⅝ | 11.2 | 150/225 |
| 16 | 13 | 17⅞ | 4½ | 16.0 | 150/225 |

| In. | mm | mm | mm ⁽¹⁾ | kg | MPa |
|-----|-----|-----|-------------------|------|-----------|
| 1 | - | - | - | - | - |
| 1½ | - | - | - | - | - |
| 2 | 152 | 67 | 54 | 0.18 | 2.07/3.10 |
| 3 | 152 | 95 | 60 | 0.36 | 2.07/3.10 |
| 4 | 178 | 124 | 73 | 0.64 | 2.07/3.10 |
| 6 | 213 | 181 | 86 | 1.27 | 2.07/3.10 |
| 8 | 254 | 229 | 98 | 1.50 | 1.03/1.55 |
| 10 | 268 | 283 | 89 | 2.13 | 1.03/1.55 |
| 12 | 279 | 333 | 98 | 3.08 | 1.03/1.55 |
| 14 | 318 | 381 | 111 | 5.08 | 1.03/1.55 |
| 16 | 330 | 435 | 114 | 7.26 | 1.03/1.55 |

NIPPLES

GT - GREEN THREAD
 RT - RED THREAD
 □ - STANDARD AVAILABLE SIZE

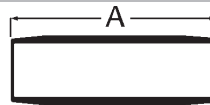

| Size | Close | | 4" | | 6" | | 8" | | 10" | | 12" | | 16" | | 24" | | 36" | |
|------|-------|-----|----|------------------|------------------|------------------|----|----|-----|----|-----|----|-----|----|-----|----|-----|--|
| | In. | GT | RT | GT | RT | GT | RT | GT | RT | GT | RT | GT | RT | GT | RT | GT | RT | |
| 1 | 2½ | - | - | - | □ | - | □ | - | - | - | - | - | - | - | - | - | - | |
| 1½ | 3⅝ | - | - | - | □ | - | □ | - | - | - | - | - | - | - | - | - | - | |
| 2 | 4½ | □ | - | □ ⁽³⁾ | □ | □ | □ | □ | - | □ | - | □ | - | - | - | - | - | |
| 3 | 5⅝ | 5⅝ | - | - | □ | □ ⁽⁴⁾ | □ | □ | - | □ | - | □ | - | - | - | - | - | |
| 4 | 5¾ | 5¾ | - | - | □ | □ | □ | □ | - | □ | - | □ | - | - | - | - | - | |
| 6 | 6⅝ | 6⅝ | - | - | □ ⁽⁴⁾ | □ ⁽⁵⁾ | □ | □ | - | □ | □ | □ | - | - | - | - | - | |
| 8 | 8⅝ | 9⅝ | - | - | - | - | - | - | - | - | □ | □ | □ | □ | - | □ | - | |
| 10 | 9¾ | 9¾ | - | - | - | - | - | - | - | - | □ | □ | □ | □ | - | □ | - | |
| 12 | 9¾ | 10¼ | - | - | - | - | - | - | - | - | □ | □ | □ | □ | - | □ | - | |
| 14 | - | □ | - | - | - | - | - | - | - | - | - | - | □ | □ | - | □ | - | |
| 16 | - | - | - | - | - | - | - | - | - | - | - | - | □ | □ | - | □ | - | |

⁽¹⁾This is a nominal make-up dimension for drawing layout work only. Do not use for assembly dimensions.

⁽²⁾Flanges should be joined only to flat-faced flanges. See Smith Fibercast Installation Instructions for valve, bolt, and gasket recommendations.

⁽³⁾Actual length 4¼"

⁽⁴⁾Actual length 6¼"

⁽⁵⁾Actual length 6⅝"



END CAPS (Parts are available in GREEN THREAD only.)

| Nom. Pipe Size | A | X ⁽¹⁾ With GT Pipe | X ⁽¹⁾ With RTII Pipe | Nominal Wgt. | Cyclic/ Steady Pressure | A | X ⁽¹⁾ With GT Pipe | X ⁽¹⁾ With RTII Pipe | Nominal Wgt. | Cyclic/ Steady Pressure |
|----------------|----|-------------------------------|---------------------------------|--------------|-------------------------|-----|-------------------------------|---------------------------------|--------------|-------------------------|
| | | In. | In. | | | | In. | In. | | |
| 1 | 2¾ | 1 | - | .3 | 300/450 | 70 | 25 | - | 0.14 | 2.07/3.10 |
| 1½ | 2⅝ | 1⅝ | - | .6 | 300/450 | 67 | 35 | - | 0.27 | 2.07/3.10 |
| 2 | 2¾ | 1⅝ | 1⅝ | 1.4 | 300/450 | 70 | 41 | 35 | 0.64 | 2.07/3.10 |
| 3 | 3¼ | 2⅝ | 1⅝ | 1.9 | 300/450 | 83 | 54 | 41 | 0.86 | 2.07/3.10 |
| 4 | 3¾ | 2 | 1½ | 3.0 | 150/225 | 95 | 51 | 38 | 1.36 | 1.03/1.55 |
| 6 | 7 | 2⅝ | 2¾ | 4.2 | 150/225 | 178 | 73 | 60 | 1.91 | 1.03/1.55 |
| 8 | 8¾ | 3⅝ | 4¾ | 5.6 | 150/225 | 222 | 86 | 111 | 2.54 | 1.03/1.55 |
| 10 | 9¾ | 3⅝ | 4⅝ | 8.4 | 150/225 | 251 | 98 | 105 | 3.81 | 1.03/1.55 |
| 12 | 11 | 4 | 4¼ | 12.5 | 150/225 | 279 | 102 | 108 | 5.67 | 1.03/1.55 |
| 14 | 12 | 3⅝ | 3⅝ | 15.6 | 150/225 | 305 | 92 | 92 | 7.08 | 1.03/1.55 |
| 16 | 13 | 3⅝ | 3⅝ | 19.5 | 150/225 | 330 | 92 | 92 | 8.85 | 1.03/1.55 |

ADAPTERS (1" and 1½" parts are available in GREEN THREAD only; 2"-8" parts are available in GREEN THREAD or RED THREAD II; 10" and 12" parts are available in RED THREAD II only.)

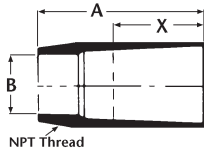

BELL x MALE

⁽¹⁾This is a nominal make-up dimension for drawing layout work only. Do not use for assembly dimensions.
⁽²⁾Do not pressurize over 1½ times the maximum operating pressure

| Nom. Pipe Size | A | B | X ⁽¹⁾ With GT Pipe | X ⁽¹⁾ With RTII Pipe | Nom. Wgt. GT | Nom. Wgt. RT II | Cyclic/ Steady Pressure | Nom. Pipe Size | A | B | X ⁽¹⁾ With GT Pipe | X ⁽¹⁾ With RT II Pipe | Nom. Wgt. GT | Nom. Wt. RTII | Cyclic/ Steady Pressure |
|----------------|-----|-----|-------------------------------|---------------------------------|--------------|-----------------|-------------------------|----------------|-----|-----|-------------------------------|----------------------------------|--------------|---------------|-------------------------|
| In. | In. | In. | In. | In. | Lbs. | Lbs. | psig | mm | mm | mm | mm | mm | kg | kg | MPa |
| 1 | 3½ | 1 | 1 | - | .1 | - | 300/450 | 25 | 89 | 25 | 27 | - | 0.05 | - | 2.07/3.10 |
| 1½ | 3¾ | 1½ | 1⅜ | - | .3 | - | 300/450 | 38 | 99 | 38 | 35 | - | 0.14 | - | 2.07/3.10 |
| 2 | 4¼ | 2 | 1⅝ | 1⅝ | .4 | .3 | 300/450 | 51 | 108 | 51 | 41 | 35 | 0.18 | 0.14 | 2.07/3.10 |
| 3 | 5½ | 3 | 2⅞ | 1⅞ | .9 | .6 | 200/300 | 76 | 140 | 76 | 54 | 41 | 0.41 | 0.27 | 1.38/2.07 |
| 4 | 5½ | 4 | 2 | 1½ | 1.6 | 1.0 | 150/225 | 102 | 140 | 102 | 51 | 38 | 0.73 | 0.45 | 1.03/1.55 |
| 6 | 6 | 6 | 2⅞ | 2⅞ | 2.6 | 1.8 | 150/225 | 152 | 152 | 152 | 73 | 60 | 1.18 | 0.82 | 1.03/1.55 |
| 8 | 9¼ | 8 | 2⅞ | 3⅞ | 7.2 | 6.6 | 150/225 | 203 | 235 | 203 | 73 | 98 | 3.27 | 2.99 | 1.03/1.55 |

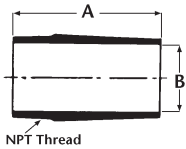

SPIGOT x MALE

| Nom. Pipe Size | A | B | X ⁽¹⁾ With GT Pipe | X ⁽¹⁾ With RTII Pipe | Nom. Wgt. GT | Nom. Wgt. RT II | Cyclic/ Steady Pressure | Nom. Pipe Size | A | B | X ⁽¹⁾ With GT Pipe | X ⁽¹⁾ With RT II Pipe | Nom. Wgt. GT | Nom. Wt. RTII | Cyclic/ Steady Pressure |
|----------------|-----|-----|-------------------------------|---------------------------------|--------------|-----------------|-------------------------|----------------|-----|-----|-------------------------------|----------------------------------|--------------|---------------|-------------------------|
| In. | In. | In. | In. | In. | Lbs. | Lbs. | psig | mm | mm | mm | mm | mm | kg | kg | MPa |
| 1 | 2⅞ | 1 | - | - | .1 | - | 300/450 | 25 | 67 | 25 | - | - | 0.05 | - | 2.07/3.10 |
| 1½ | 2¾ | 1¼ | - | - | .3 | - | 300/450 | 38 | 70 | 38 | - | - | 0.14 | - | 2.07/3.10 |
| 2 | 3⅝ | 2 | - | - | .4 | .3 | 300/450 | 51 | 92 | 51 | - | - | 0.18 | .1 | 2.07/3.10 |
| 3 | 4⅝ | 3 | - | - | .9 | .6 | 200/300 | 76 | 117 | 76 | - | - | 0.41 | .2 | 1.38/2.07 |
| 4 | 4⅞ | 4 | - | - | 1.1 | 1.0 | 150/225 | 102 | 124 | 102 | - | - | 0.50 | .4 | 1.03/1.55 |
| 6 | 6⅞ | 6 | - | - | 2.6 | 2.0 | 150/225 | 152 | 175 | 152 | - | - | 1.18 | .9 | 1.03/1.55 |
| 8 | 8 | 8 | - | - | 5.6 | 4.9 | 150/225 | 203 | 203 | 203 | - | - | 2.54 | 2.2 | 1.03/1.55 |

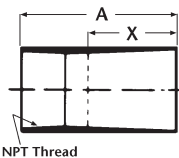

BELL X FEMALE

| Nom. Pipe Size | A | B | X ⁽¹⁾ With GT Pipe | X ⁽¹⁾ With RTII Pipe | Nom. Wgt. GT | Nom. Wgt. RT II | Cyclic/ Steady Pressure | Nom. Pipe Size | A | B | X ⁽¹⁾ With GT Pipe | X ⁽¹⁾ With RT II Pipe | Nom. Wgt. GT | Nom. Wt. RTII | Cyclic/ Steady Pressure |
|----------------|-----|-----|-------------------------------|---------------------------------|--------------|-----------------|-------------------------|----------------|-----|----|-------------------------------|----------------------------------|--------------|---------------|-------------------------|
| In. | In. | In. | In. | In. | Lbs. | Lbs. | psig | mm | mm | mm | mm | mm | kg | kg | MPa |
| 1 | 2⅞ | - | 1 | - | .1 | - | 300/450 | 25 | 67 | - | 27 | - | 0.05 | - | 2.07/3.10 |
| 1½ | 2¾ | - | 1⅜ | - | .3 | - | 300/450 | 38 | 70 | - | 35 | - | 0.14 | - | 2.07/3.10 |
| 2 | 3½ | - | 1⅝ | 1⅝ | .6 | .3 | 300/450 | 51 | 89 | - | 41 | 35 | 0.27 | .1 | 2.07/3.10 |
| 3 | 4½ | - | 2⅞ | 1⅞ | .6 | .5 | 200/300 | 76 | 114 | - | 54 | 41 | 0.27 | .2 | 1.38/2.07 |
| 4 | 4½ | - | 2 | 1½ | .6 | .5 | 150/225 | 102 | 114 | - | 51 | 38 | 0.27 | .2 | 1.03/1.55 |
| 6 | 5½ | - | 2⅞ | 2⅞ | 1.9 | 1.3 | 150/225 | 152 | 140 | - | 73 | 60 | 0.86 | .6 | 1.03/1.55 |
| 8 | 7 | - | 2⅞ | 3⅞ | 5.1 | 3.5 | 100/150 | 203 | 178 | - | 73 | 98 | 2.31 | 1.6 | 0.69/1.03 |

ADAPTERS (1" and 1½" parts are available in GREEN THREAD only; 2"-8" parts are available in GREEN THREAD or RED THREAD II; 10" and 12" parts are available in RED THREAD II only.)

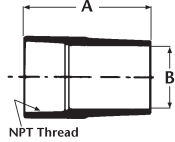

SPIGOT x FEMALE

(1)This is a nominal make-up dimension for drawing layout work only. Do not use for assembly dimensions.
 (2)Do not pressurize over 1½ times the maximum operating pressure

| Nom. Pipe Size | A | B | X ⁽¹⁾ With GT Pipe | X ⁽¹⁾ With RTII Pipe | Nom. Wgt. GT | Nom. Wgt. RT II | Cyclic/ Steady Pressure | Nom. Pipe Size | A | B | X ⁽¹⁾ With GT Pipe | X ⁽¹⁾ With RT II Pipe | Nom. Wgt. GT | Nom. Wt. RTII | Cyclic/ Steady Pressure |
|----------------|-------------------------------|-------------------------------|-------------------------------|---------------------------------|--------------|-----------------|-------------------------|----------------|-----|-----|-------------------------------|----------------------------------|--------------|---------------|-------------------------|
| In. | In. | In. | In. | In. | Lbs. | Lbs. | psig | mm | mm | mm | mm | mm | kg | kg | MPa |
| 1 | 3 ⁵ / ₈ | 1 | - | - | .2 | - | 300/450 | 25 | 92 | 25 | - | - | 0.09 | - | 2.07/3.10 |
| 1½ | 4 | 1½ | - | - | .3 | - | 300/450 | 38 | 102 | 38 | - | - | 0.14 | - | 2.07/3.10 |
| 2 | 3 ⁷ / ₈ | 2 | - | - | .4 | .3 | 300/450 | 51 | 98 | 51 | - | - | 0.18 | 0.14 | 2.07/3.10 |
| 3 | 4 ³ / ₄ | 3 ³ / ₈ | - | - | .8 | .5 | 200/300 | 76 | 121 | 76 | - | - | 0.36 | 0.23 | 1.38/2.07 |
| 4 | 4 ⁷ / ₈ | 4 ¹ / ₈ | - | - | 1.0 | .6 | 150/225 | 102 | 124 | 102 | - | - | 0.45 | 0.27 | 1.03/1.55 |
| 6 | 6 ³ / ₄ | 6 | - | - | 3.4 | 2.6 | 150/225 | 152 | 171 | 152 | - | - | 1.54 | 1.18 | 1.03/1.55 |
| 8 | 10 | 8 | - | - | 8.0 | 7.1 | 100/150 | 203 | 254 | 203 | - | - | 3.63 | 3.22 | 0.69/1.03 |

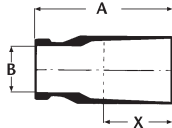

BELL x GROOVED⁽²⁾

| Nom. Pipe Size | A | B | X ⁽¹⁾ With GT Pipe | X ⁽¹⁾ With RTII Pipe | Nom. Wgt. GT | Nom. Wgt. RT II | Cyclic/ Steady Pressure | Nom. Pipe Size | A | B | X ⁽¹⁾ With GT Pipe | X ⁽¹⁾ With RT II Pipe | Nom. Wgt. GT | Nom. Wt. RTII | Cyclic/ Steady Pressure |
|----------------|-------------------------------|--------------------------------|-------------------------------|---------------------------------|--------------|-----------------|-------------------------|----------------|-----|-----|-------------------------------|----------------------------------|--------------|---------------|-------------------------|
| In. | In. | In. | In. | In. | Lbs. | Lbs. | psig | mm | mm | mm | mm | mm | kg | kg | MPa |
| 1 | 3½ | 7/8 | 1 | - | .3 | - | 300/450 | 25 | 89 | 22 | 27 | - | 0.14 | - | 2.07/3.10 |
| 1½ | 3 ³ / ₈ | 1½ | 1 ³ / ₈ | - | .5 | - | 300/450 | 38 | 98 | 38 | 35 | - | 0.23 | - | 2.07/3.10 |
| 2 | 4¼ | 2 | 1 ⁵ / ₈ | 1 ³ / ₈ | .5 | .3 | 300/450 | 51 | 108 | 51 | 41 | 35 | 0.23 | 0.14 | 2.07/3.10 |
| 3 | 5 | 3 | 2 ¹ / ₈ | 1 ⁵ / ₈ | .9 | .6 | 200/300 | 76 | 127 | 76 | 54 | 41 | 0.41 | 0.27 | 1.38/2.07 |
| 4 | 5 | 4 | 2 | 1½ | 1.0 | .8 | 150/225 | 102 | 127 | 102 | 51 | 38 | 0.45 | 0.63 | 1.03/1.55 |
| 6 | 5 ⁵ / ₈ | 6 | 2 ⁷ / ₈ | 2 ³ / ₈ | 2.3 | 1.8 | 150/225 | 152 | 143 | 152 | 73 | 60 | 1.04 | 0.84 | 1.03/1.55 |
| 8 | 8¼ | 8 | 2 ⁷ / ₈ | 3 ³ / ₈ | 5.8 | 4.9 | 150/225 | 203 | 210 | 203 | 73 | 98 | 2.63 | 2.22 | 1.03/1.55 |
| 10 | 8¼ | 10 ¹ / ₈ | - | 3½ | - | 6.3 | 125/190 | 254 | 210 | 257 | - | 89 | - | 2.86 | 0.86/1.31 |

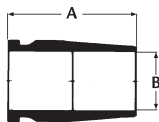

SPIGOT x GROOVED⁽²⁾

| Nom. Pipe Size | A | B | X ⁽¹⁾ With GT Pipe | X ⁽¹⁾ With RTII Pipe | Nom. Wgt. GT | Nom. Wgt. RT II | Cyclic/ Steady Pressure | Nom. Pipe Size | A | B | X ⁽¹⁾ With GT Pipe | X ⁽¹⁾ With RT II Pipe | Nom. Wgt. GT | Nom. Wt. RTII | Cyclic/ Steady Pressure |
|----------------|-------------------------------|--------------------------------|-------------------------------|---------------------------------|--------------|-----------------|-------------------------|----------------|-----|-----|-------------------------------|----------------------------------|--------------|---------------|-------------------------|
| In. | In. | In. | In. | In. | Lbs. | Lbs. | psig | mm | mm | mm | mm | mm | kg | kg | MPa |
| 1 | 2¾ | 7/8 | - | - | .1 | - | 300/450 | 25 | 70 | 22 | - | - | 0.05 | - | 2.07/3.10 |
| 1½ | 3 ³ / ₈ | 1½ | - | - | .2 | - | 300/450 | 38 | 79 | 38 | - | - | 0.09 | - | 2.07/3.10 |
| 2 | 3 ⁵ / ₈ | 2 | - | - | .3 | .3 | 300/450 | 51 | 92 | 51 | - | - | 0.14 | 0.14 | 2.07/3.10 |
| 3 | 4¼ | 3 | - | - | .9 | .6 | 200/300 | 76 | 127 | 76 | - | - | 0.41 | 0.27 | 1.38/2.07 |
| 4 | 4½ | 4 | - | - | 1.0 | .9 | 150/225 | 102 | 114 | 102 | - | - | 0.45 | 0.41 | 1.03/1.55 |
| 6 | 5 | 6 | - | - | 2.6 | 2.0 | 150/225 | 152 | 127 | 152 | - | - | 1.18 | 0.91 | 1.03/1.55 |
| 8 | 7 | 8 | - | - | 4.4 | 4.1 | 150/225 | 203 | 178 | 203 | - | - | 2.00 | 1.86 | 1.03/1.55 |
| 10 | 7 | 10 ¹ / ₈ | - | - | - | 5.6 | 125/190 | 254 | 178 | 257 | - | - | - | 2.54 | 0.86/1.31 |
| 12 | 7 | 12 | - | - | - | 6.8 | 100/150 | 305 | 178 | 305 | - | - | - | 3.08 | 0.69/1.03 |

REDUCERS (1"-16 parts are available in GREEN THREAD only.)

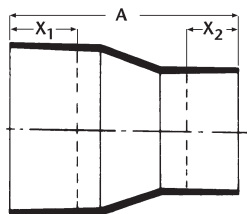

CONCENTRIC REDUCER BELLED

| Nom. Pipe Size | A | X ₁ ⁽¹⁾ With GT Pipe | X ₂ ⁽¹⁾ With Gt Pipe | X ₁ ⁽¹⁾ With RT II Pipe | X ₂ ⁽¹⁾ With RT II Pipe | Nom. Wgt. | Cyclic/ Steady Pressure | Nom. Pipe Size | A | X ₁ ⁽¹⁾ With GT Pipe | X ₂ ⁽¹⁾ With GT Pipe | X ₁ ⁽¹⁾ With RT II Pipe | X ₂ ⁽¹⁾ With RT II Pipe | Nom. Wgt. | Cyclic/ Steady Pressure |
|----------------|-----|--|--|---|---|-----------|-------------------------|----------------|-----|--|--|---|---|-----------|--------------------------|
| In. | In. | In. | In. | In. | In. | Lbs. | psig | mm | mm | mm | mm | mm | mm | kg | MPa |
| 2x1 | 5½ | 1⅝ | 1⅜ | 1⅜ | 1⅜ | .6 | 300/450 | 51x25 | 140 | 41 | 35 | 35 | 35 | 0.27 | 2.07/3.10 |
| 2x1½ | 5½ | 1⅝ | 1⅜ | 1⅜ | 1⅜ | .6 | 300/450 | 51x38 | 140 | 41 | 35 | 35 | 35 | 0.27 | 2.07/3.10 |
| 3x1½ | 7⅞ | 2⅞ | 1⅝ | 1⅝ | 1⅜ | 1.3 | 300/450 | 76x38 | 181 | 54 | 41 | 41 | 35 | 0.59 | 2.07/3.10 |
| 3x2 | 7⅞ | 2⅞ | 1⅝ | 1⅝ | 1⅜ | 1.3 | 300/450 | 76x51 | 181 | 54 | 41 | 41 | 35 | 0.59 | 2.07/3.10 |
| 4x2 | 7⅞ | 2 | 2⅞ | 1½ | 1⅝ | 1.9 | 150/225 ⁽²⁾ | 102x51 | 200 | 51 | 54 | 38 | 41 | 0.86 | 1.03/1.55 ⁽²⁾ |
| 4x3 | 7⅞ | 2 | 2⅞ | 1½ | 1⅝ | 1.9 | 150/225 ⁽²⁾ | 102x76 | 200 | 51 | 54 | 38 | 41 | 0.86 | 1.03/1.55 ⁽²⁾ |
| 6x3 | 11¼ | 2⅞ | 2 | 2⅞ | 1½ | 4.3 | 150/225 ⁽²⁾ | 152x76 | 286 | 73 | 51 | 60 | 38 | 1.95 | 1.03/1.55 ⁽²⁾ |
| 6x4 | 11¼ | 2⅞ | 2 | 2⅞ | 1½ | 4.3 | 150/225 ⁽²⁾ | 152x102 | 286 | 73 | 51 | 60 | 38 | 1.95 | 1.03/1.55 ⁽²⁾ |
| 8x4 | 15¼ | 3⅝ | 3⅝ | 4⅝ | 2⅞ | 7.3 | 150/225 | 203x102 | 387 | 86 | 86 | 111 | 73 | 3.31 | 1.03/1.55 |
| 8x6 | 15¼ | 3⅝ | 3⅝ | 4⅝ | 2⅞ | 7.3 | 150/225 | 203x152 | 387 | 86 | 86 | 111 | 73 | 3.31 | 1.03/1.55 |
| 10x6 | 16½ | 3⅝ | 3⅝ | 4⅝ | 4⅝ | 11.1 | 150/225 | 254x152 | 419 | 98 | 86 | 105 | 111 | 5.03 | 1.03/1.55 |
| 10x8 | 16½ | 3⅝ | 3⅝ | 4⅝ | 4⅝ | 11.1 | 150/225 | 254x203 | 419 | 98 | 86 | 105 | 111 | 5.03 | 1.03/1.55 |
| 12x8 | 17¾ | 4 | 3⅞ | 4¼ | 4⅝ | 16.4 | 150/225 | 305x203 | 451 | 102 | 98 | 108 | 105 | 7.44 | 1.03/1.55 |
| 12x10 | 17¾ | 4 | 3⅞ | 4¼ | 4⅝ | 16.4 | 150/225 | 305x254 | 451 | 102 | 98 | 108 | 105 | 7.44 | 1.03/1.55 |
| 14x10 | 19¾ | 3⅝ | 4¼ | 3⅝ | 4¼ | 18.9 | 150/225 | 356x254 | 502 | 92 | 108 | 92 | 108 | 8.57 | 1.03/1.55 |
| 14x12 | 19¾ | 3⅝ | 4¼ | 3⅝ | 4¼ | 18.9 | 150/225 | 356x305 | 502 | 92 | 108 | 92 | 108 | 8.57 | 1.03/1.55 |
| 16x12 | 22 | 3⅝ | 3⅝ | 3⅝ | 3⅝ | 24.4 | 150/225 | 406x305 | 560 | 92 | 92 | 92 | 92 | 11.07 | 1.03/1.55 |
| 16x14 | 22 | 3⅝ | 3⅝ | 3⅝ | 3⅝ | 24.4 | 150/225 | 406x356 | 560 | 92 | 92 | 92 | 92 | 11.07 | 1.03/1.55 |

NOTE: MULTI-STEP and ECCENTRIC reducers are available through 16" sizes. Information is available on request.

⁽¹⁾This is a nominal make-up dimension for drawing layout work only. Do not use for assembly dimensions.

⁽²⁾Also available on special order for 300 psig cyclic and 450 psig steady pressure service with belled ends.

⁽³⁾Flanges should be joined only to flat-faced flanges. See Smith Fibercast Installation Instructions for valve, torque, bolt, and gasket recommendations.

These comments also apply to the flanged concentric reducers on the following page.

REDUCERS (1"-16 parts are available in GREEN THREAD only.)

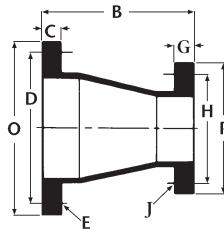

CONCENTRIC REDUCER FLANGED⁽³⁾

| Nom. Pipe Size | B | C | D | E | O | G | H | J | P | Nom. Wgt. | Cyclic/ Steady Pressure |
|----------------|-----|-------|--------|-------------------|--------|-------|--------|-------------------|--------|-----------|-------------------------|
| In. | In. | In. | In. | In. | In. | In. | In. | In. | In. | Lbs. | psig |
| 2x1 | 5 | 3/4 | 4 3/4 | 3/4D - 4 holes | 6 | 3/4 | 3 7/8 | 5/8D - 4 holes | 4 1/4 | 2.6 | 200/300 |
| 2x1 1/2 | 5 | 3/4 | 4 3/4 | 3/4D - 4 holes | 6 | 3/4 | 3 7/8 | 5/8D - 4 holes | 5 | 2.6 | 200/300 |
| 3x1 1/2 | 6 | 1 1/8 | 6 | 3/4D - 4 holes | 7 1/2 | 3/4 | 4 3/4 | 3/4D - 4 holes | 5 | 4.4 | 125/190 |
| 3x2 | 6 | 1 1/8 | 6 | 3/4D - 4 holes | 7 1/2 | 3/4 | 4 3/4 | 3/4D - 4 holes | 6 | 4.4 | 125/190 |
| 4x2 | 7 | 1 1/8 | 7 1/2 | 3/4D - 8 holes | 9 | 1 1/8 | 6 | 3/4D - 4 holes | 6 | 7.1 | 100/150 |
| 4x3 | 7 | 1 1/8 | 7 1/2 | 3/4D - 8 holes | 9 | 1 1/8 | 6 | 3/4D - 4 holes | 7 1/2 | 7.1 | 100/150 |
| 6x3 | 9 | 1 1/2 | 9 1/2 | 7/8D - 8 holes | 11 | 1 3/8 | 7 1/2 | 3/4D - 8 holes | 7 1/2 | 11.0 | 100/150 |
| 6x4 | 9 | 1 1/2 | 9 1/2 | 7/8D - 8 holes | 11 | 1 3/8 | 7 1/2 | 3/4D - 8 holes | 9 | 11.0 | 100/150 |
| 8x4 | 11 | 1 3/4 | 11 3/4 | 7/8D - 8 holes | 13 1/2 | 1 1/2 | 9 1/2 | 7/8D - 8 holes | 9 | 17.6 | 150/225 |
| 8x6 | 11 | 1 3/4 | 11 3/4 | 7/8D - 8 holes | 13 1/2 | 1 1/2 | 9 1/2 | 7/8D - 8 holes | 11 | 17.6 | 150/225 |
| 10x6 | 12 | 2 | 14 1/4 | 1D - 12 holes | 16 | 1 3/4 | 11 3/4 | 7/8D - 8 holes | 11 | 28.2 | 150/225 |
| 10x8 | 12 | 2 | 14 1/4 | 1D - 12 holes | 16 | 1 3/4 | 11 3/4 | 7/8D - 8 holes | 13 1/2 | 28.2 | 150/225 |
| 12x8 | 14 | 2 1/4 | 17 | 1D - 12 holes | 19 | 2 | 14 1/4 | 1D - 12 holes | 13 1/2 | 43.0 | 150/225 |
| 12x10 | 14 | 2 1/4 | 17 | 1D - 12 holes | 19 | 2 | 14 1/4 | 1D - 12 holes | 16 | 43.0 | 150/225 |
| 14x10 | 16 | 2 1/2 | 18 3/4 | 1 1/8D - 12 holes | 20 3/4 | 2 1/4 | 17 | 1D - 12 holes | 16 | 55.0 | 150/225 |
| 14x12 | 16 | 2 1/2 | 18 3/4 | 1 1/8D - 12 holes | 20 3/4 | 2 1/4 | 17 | 1D - 12 holes | 19 | 55.0 | 150/225 |
| 16x12 | 18 | 2 1/2 | 21 1/4 | 1 1/8D - 16 holes | 23 1/4 | 2 1/2 | 18 3/4 | 1 1/8D - 12 holes | 19 | 89.5 | 150/225 |
| 16x14 | 18 | 2 1/2 | 21 1/4 | 1 1/8D - 16 holes | 23 1/4 | 2 1/2 | 18 3/4 | 1 1/8D - 12 holes | 20 3/4 | 89.5 | 150/225 |

| mm | mm | mm | mm | mm | mm | mm | mm | mm | mm | kg | MPa |
|---------|-----|----|-----|----------------|-----|----|-----|----------------|-----|-------|-----------|
| 51x25 | 127 | 19 | 121 | 19D - 4 holes | 152 | 19 | 98 | 16D - 4 holes | 108 | 1.18 | 1.38/2.07 |
| 51x38 | 127 | 19 | 121 | 19D - 4 holes | 152 | 19 | 98 | 16D - 4 holes | 127 | 1.18 | 1.38/2.07 |
| 76x38 | 152 | 35 | 152 | 19D - 4 holes | 191 | 19 | 121 | 19D - 4 holes | 127 | 2.00 | 0.86/1.31 |
| 76x51 | 152 | 35 | 152 | 19D - 4 holes | 191 | 19 | 121 | 19D - 4 holes | 152 | 2.00 | 0.86/1.31 |
| 102x51 | 178 | 35 | 191 | 19D - 8 holes | 229 | 35 | 152 | 19D - 4 holes | 152 | 3.22 | 0.69/1.03 |
| 102x76 | 178 | 35 | 191 | 19D - 8 holes | 229 | 35 | 152 | 19D - 4 holes | 191 | 3.22 | 0.69/1.03 |
| 152x76 | 229 | 38 | 241 | 22D - 8 holes | 279 | 35 | 191 | 19D - 8 holes | 191 | 4.99 | 0.69/1.03 |
| 152x102 | 229 | 38 | 241 | 22D - 8 holes | 279 | 35 | 191 | 19D - 8 holes | 229 | 4.99 | 0.69/1.03 |
| 203x102 | 279 | 44 | 298 | 22D - 8 holes | 343 | 38 | 241 | 22D - 8 holes | 229 | 7.98 | 1.03/1.55 |
| 203x152 | 279 | 44 | 298 | 22D - 8 holes | 343 | 38 | 241 | 22D - 8 holes | 279 | 7.98 | 1.03/1.55 |
| 254x152 | 305 | 51 | 362 | 25D - 12 holes | 406 | 44 | 298 | 22D - 8 holes | 279 | 12.79 | 1.03/1.55 |
| 254x203 | 305 | 51 | 362 | 25D - 12 holes | 406 | 44 | 298 | 22D - 8 holes | 343 | 12.79 | 1.03/1.55 |
| 305x203 | 356 | 57 | 432 | 25D - 12 holes | 483 | 51 | 362 | 25D - 12 holes | 343 | 19.50 | 1.03/1.55 |
| 305x254 | 356 | 57 | 432 | 25D - 12 holes | 483 | 51 | 362 | 25D - 12 holes | 406 | 19.50 | 1.03/1.55 |
| 356x254 | 406 | 64 | 476 | 29D - 12 holes | 527 | 57 | 432 | 25D - 12 holes | 406 | 24.95 | 1.03/1.55 |
| 356x305 | 406 | 64 | 476 | 29D - 12 holes | 527 | 57 | 432 | 25D - 12 holes | 483 | 24.95 | 1.03/1.55 |
| 406x305 | 457 | 64 | 540 | 29D - 16 holes | 591 | 64 | 476 | 29D - 12 holes | 483 | 40.60 | 1.03/1.55 |
| 406x356 | 457 | 64 | 540 | 29D - 16 holes | 591 | 64 | 476 | 29D - 12 holes | 527 | 40.60 | 1.03/1.55 |

REDUCER BUSHING

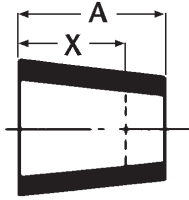

REDUCER BUSHING

| Nom. Pipe Size | A | X ⁽¹⁾ With GT Pipe | X ⁽¹⁾ With RTII Pipe | Nom. Wgt. | Cyclic/ Steady Pressure | Nom. Pipe Size | A | X ⁽¹⁾ With GT Pipe | X ⁽¹⁾ With RTII Pipe | Nom. Wgt. | Cyclic/ Steady Pressure |
|-----------------------|-----------------|-------------------------------|---------------------------------|-----------|-------------------------|----------------|-----|-------------------------------|---------------------------------|-----------|-------------------------|
| In. | In. | In. | In. | Lbs | psig | mm | mm | mm | mm | kg | MPa |
| * | 1 $\frac{1}{8}$ | - | - | .1 | 300/450 | * | 29 | - | - | 0.05 | 2.07/3.10 |
| ** | 1 $\frac{3}{8}$ | - | - | .1 | 300/450 | * | 35 | - | - | 0.05 | 2.07/3.10 |
| 2x1 | 2 $\frac{1}{4}$ | 1 | - | .4 | 300/450 | 51x25 | 57 | 25 | - | 0.18 | 2.07/3.10 |
| 2x1 NPT | 1 $\frac{3}{4}$ | - | - | .4 | 300/450 | 51x25 | 44 | - | - | 0.18 | 2.07/3.10 |
| 2x1 $\frac{1}{2}$ NPT | 1 $\frac{3}{4}$ | - | - | .4 | 300/450 | 51x32 | 44 | - | - | 0.18 | 2.07/3.10 |
| 2x1 $\frac{1}{2}$ | 2 | 1 $\frac{3}{8}$ | - | .1 | 300/450 | 51x38 | 51 | 35 | - | 0.05 | 2.07/3.10 |
| 2x1 $\frac{1}{2}$ NPT | 1 $\frac{3}{4}$ | - | - | .1 | 300/450 | 51x38 | 44 | - | - | 0.05 | 2.07/3.10 |
| 3x2 | 2 $\frac{1}{4}$ | 2 | 1 $\frac{1}{2}$ | .8 | 300/450 | 76x51 | 57 | 51 | 38 | 0.36 | 2.07/3.10 |
| 4x3 | 2 $\frac{5}{8}$ | 2 $\frac{3}{8}$ | 1 $\frac{1}{8}$ | 1.0 | 300/450 | 102x76 | 67 | 60 | 47 | 0.45 | 2.07/3.10 |
| 6x4 | 3 $\frac{1}{8}$ | 2 $\frac{3}{8}$ | 1 $\frac{1}{8}$ | 3.9 | 300/450 | 152x102 | 79 | 60 | 47 | 1.77 | 2.07/3.10 |
| 8x6 | 3 $\frac{1}{4}$ | 2 $\frac{3}{4}$ | 2 $\frac{1}{4}$ | 6.8 | 150/225 | 203x152 | 83 | 70 | 57 | 3.08 | 1.03/1.55 |
| 10x8 | 4 | 2 $\frac{5}{8}$ | 3 $\frac{5}{8}$ | 9.9 | 150/225 | 254x203 | 102 | 67 | 92 | 4.49 | 1.03/1.55 |
| 12x10 | 4 $\frac{1}{2}$ | 3 $\frac{1}{8}$ | 4 $\frac{1}{8}$ | 11.8 | 150/225 | 305x254 | 114 | 98 | 105 | 5.35 | 1.03/1.55 |
| 14x12 | 5 $\frac{1}{2}$ | 5 $\frac{1}{8}$ | 5 $\frac{1}{8}$ | 20.2 | 150/225 | 356x305 | 140 | 130 | 130 | 9.16 | 1.03/1.55 |
| 16x14 | 6 | 5 $\frac{3}{4}$ | 5 $\frac{3}{4}$ | 28.9 | 150/225 | 406x356 | 152 | 146 | 146 | 13.11 | 1.03/1.55 |

* 1x $\frac{1}{4}$ NPT, 1x $\frac{1}{2}$ NPT, 1x $\frac{3}{4}$ NPT, 1 $\frac{1}{2}$ x $\frac{1}{2}$ NPT, 1 $\frac{1}{2}$ x $\frac{3}{4}$ NPT

** 1 $\frac{1}{2}$ x1NPT, 1 $\frac{1}{2}$ x1, 1 $\frac{1}{2}$ x1 $\frac{1}{4}$ NPT

NOTE: MULTI-STEP and ECCENTRIC reducers are available through 16" sizes. Information available on request.

⁽¹⁾ This is a nominal make-up dimensions for drawing layout work only. Do not use for assembly dimensions.

LATERALS (1"-2" belled laterals are available in GREEN THREAD only; 3"-16" belled laterals are available in GREEN THREAD and RED THREAD II; 1"-6" flanged laterals are available in GREEN THREAD only; 8"-16" flanged laterals are available in GREEN THREAD and RED THREAD II)

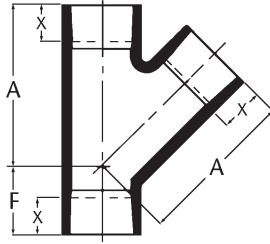

45° LATERAL BELLED

| Nom. Pipe Size | A | F | X ⁽¹⁾ With GT Pipe | X ⁽¹⁾ W/RTII Pipe | Nom. Wgt. | Cyclic/ Steady Pressure | Nom. Pipe Size | A | F | X ⁽¹⁾ With GT Pipe | X ⁽¹⁾ W/RTII Pipe | Nom. Wgt. | Cyclic/ Steady Pressure |
|----------------|--------|--------|-------------------------------|------------------------------|-----------|-------------------------|----------------|-----|-----|-------------------------------|------------------------------|-----------|-------------------------|
| In. | In. | In. | In. | In. | Lbs. | psig | mm | mm | mm | mm | mm | kg | MPa |
| 1 | 3 7/8 | 2 1/2 | 1 | - | .6 | 100/150 | 25 | 98 | 64 | 25 | - | 0.27 | 0.69/1.03 |
| 1 1/2 | 5 1/4 | 3 3/4 | 1 3/8 | - | 1.3 | 100/150 | 38 | 133 | 83 | 35 | - | 0.59 | 0.69/1.03 |
| 2 | 6 5/8 | 2 3/4 | 1 5/8 | 1 3/8 | 4.1 | 300/450 | 51 | 168 | 70 | 41 | 35 | 1.86 | 2.07/3.10 |
| 3 | 7 3/4 | 4 1/4 | 2 1/8 | 1 5/8 | 4.4 | 100/150 | 76 | 197 | 108 | 54 | 41 | 2.00 | 0.69/1.03 |
| 4 | 9 | 4 3/8 | 2 | 1 1/2 | 7.8 | 100/150 | 102 | 229 | 111 | 51 | 38 | 3.54 | 0.69/1.03 |
| 6 | 12 1/2 | 5 3/4 | 2 7/8 | 2 3/8 | 13.7 | 90/135 | 152 | 318 | 146 | 73 | 60 | 6.21 | 0.62/0.93 |
| 8 | 16 1/4 | 7 5/8 | 2 7/8 | 3 3/8 | 33.7 | 90/135 | 203 | 413 | 187 | 73 | 98 | 15.29 | 0.62/0.93 |
| 10 | 19 5/8 | 8 3/4 | 3 1/4 | 3 1/2 | 53.3 | 80/120 | 254 | 498 | 222 | 83 | 89 | 24.17 | 0.55/0.83 |
| 12 | 24 3/4 | 11 3/4 | 3 5/8 | 3 7/8 | 96.0 | 60/90 | 305 | 629 | 298 | 92 | 98 | 43.54 | 0.41/0.62 |
| 14 | 32 1/2 | 15 3/4 | 4 3/8 | 4 3/8 | 154.2 | 50/75 | 356 | 826 | 400 | 111 | 111 | 69.94 | 0.34/0.52 |
| 16 | 35 3/4 | 17 3/4 | 4 1/2 | 4 1/2 | 222.6 | 50/75 | 406 | 908 | 451 | 114 | 114 | 101 | 0.34/0.52 |

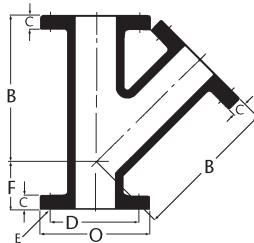

45° LATERAL FLANGED⁽²⁾

| Nom Pipe Size | B | C | D | E | F | O | Nom. Wgt. | Cyclic/ Steady Press. | Nom. Pipe Size | B | C | D | E | F | O | Nom Wgt. | Cyclic/ Steady Press. |
|---------------|--------|-------|--------|-----------------|--------|--------|-----------|-----------------------|----------------|------|----|-----|--------------|-----|-----|----------|-----------------------|
| In. | In. | In. | In. | In. | In. | In. | Lbs. | psig | mm | mm | mm | mm | mm | mm | mm | kg | MPa |
| 1 | 6 | 3/4 | 3 1/4 | 5/8D-4 holes | 4 1/2 | 4 1/4 | 2.8 | 100/150 | 25 | 152 | 19 | 83 | 16D-4 holes | 114 | 108 | 1.27 | 0.69/1.03 |
| 1 1/2 | 8 1/2 | 3/4 | 3 3/8 | 5/8D-4 holes | 5 1/2 | 5 | 4.4 | 100/150 | 38 | 216 | 19 | 98 | 16D-4 holes | 140 | 127 | 2.00 | 0.69/1.03 |
| 2 | 8 7/8 | 3/4 | 4 3/4 | 3/4D-4 holes | 6 3/8 | 6 | 7.8 | 100/150 | 51 | 225 | 19 | 121 | 19D-4 holes | 162 | 152 | 3.54 | 0.69/1.03 |
| 3 | 11 3/4 | 1 1/8 | 6 | 3/4D-4 holes | 8 | 7 1/2 | 13.4 | 100/150 | 76 | 298 | 35 | 152 | 19D-4 holes | 203 | 191 | 6.08 | 0.69/1.03 |
| 4 | 12 7/8 | 1 1/8 | 7 1/2 | 3/4D-8 holes | 8 1/2 | 9 | 19.2 | 100/150 | 102 | 327 | 35 | 191 | 19D-8 holes | 216 | 229 | 8.71 | 0.69/1.03 |
| 6 | 18 | 1 1/2 | 9 1/2 | 7/8D-8 holes | 11 | 11 | 35 | 90/135 | 152 | 457 | 38 | 241 | 22D-8 holes | 279 | 279 | 15.9 | 0.62/0.93 |
| 8 | 21 3/4 | 1 3/4 | 11 3/4 | 7/8D-8 holes | 13 3/4 | 13 1/2 | 65.3 | 90/135 | 203 | 552 | 44 | 298 | 22D-8 holes | 349 | 343 | 29.6 | 0.62/0.93 |
| 10 | 26 5/8 | 2 | 14 1/4 | 1D-12 holes | 16 5/8 | 16 | 112 | 80/120 | 254 | 676 | 51 | 362 | 25D-12 holes | 422 | 406 | 50.8 | 0.55/0.83 |
| 12 | 32 | 2 1/4 | 17 | 1D-12 holes | 20 | 19 | 172 | 60/90 | 305 | 813 | 57 | 432 | 25D-12 holes | 508 | 483 | 78 | 0.41/0.62 |
| 14 | 36 | 2 1/2 | 18 3/4 | 1 1/8D-12 holes | 22 | 20 3/4 | 209 | 50/75 | 356 | 914 | 64 | 476 | 29D-12 holes | 559 | 527 | 94.6 | 0.34/0.52 |
| 16 | 40 | 2 1/2 | 21 1/4 | 1 1/8D-16 holes | 24 | 23 1/4 | 267 | 50/75 | 406 | 1016 | 64 | 540 | 29D-16 holes | 610 | 594 | 121 | 0.34/0.52 |

⁽¹⁾This is a nominal make-up dimension for drawing layout work only. Do not use for assembly dimensions.

⁽²⁾Flanges should be joined only to flat-faced flanges. See Smith Fibercast Installation Instructions for valve, torque, bolt, and gasket recommendations.

CROSSES (1"-6" parts are available in GREEN THREAD only; 8"-16" parts are available in GREEN THREAD and RED THREAD II)

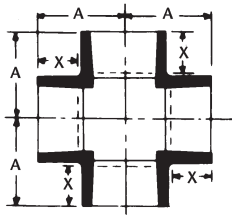

CROSS BELLED

| Nom. Pipe Size | A | X ⁽¹⁾ With GT Pipe | X ⁽¹⁾ W/RTII Pipe | Nom. Wgt. | Cyclic/ Steady Pressure | Nom. Pipe Size | A | X ⁽¹⁾ With GT Pipe | X ⁽¹⁾ W/RTII Pipe | Nom. Wgt. | Cyclic/ Steady Pressure |
|----------------|-----|-------------------------------|------------------------------|-----------|-------------------------|----------------|-----|-------------------------------|------------------------------|-----------|-------------------------|
| In. | In. | In. | In. | Lbs. | 200/300 | mm | mm | mm | mm | kg | MPa |
| 1 | 2¾ | 1 | - | 1.4 | 200/300 | 25 | 70 | 25 | - | 0.64 | 1.38/2.07 |
| 1½ | 3¾ | 1¾ | - | 2.0 | 200/300 | 38 | 86 | 35 | - | 0.91 | 1.38/2.07 |
| 2 | 3¾ | 1⅝ | 1⅝ | 3.4 | 125/190 | 51 | 86 | 41 | 35 | 1.54 | 1.38/2.07 |
| 3 | 4⅝ | 2⅞ | 1⅝ | 8.5 | 100/150 | 76 | 117 | 54 | 41 | 3.86 | 0.86/1.31 |
| 4 | 5⅝ | 2 | 1½ | 10.7 | 100/150 | 102 | 130 | 51 | 38 | 4.85 | 0.69/1.03 |
| 6 | 6⅝ | 2⅞ | 2¾ | 17.3 | 100/150 | 152 | 156 | 73 | 60 | 7.85 | 0.69/1.03 |
| 8 | 11⅝ | 2⅞ | 3⅞ | 30.8 | 100/150 | 203 | 295 | 73 | 98 | 13.97 | 0.69/1.03 |
| 10 | 13⅝ | 3¼ | 3½ | 42.7 | 100/150 | 254 | 333 | 83 | 89 | 19.37 | 0.69/1.03 |
| 12 | 14 | 3⅝ | 3⅞ | 73.2 | 100/150 | 305 | 356 | 92 | 98 | 33.20 | 0.69/1.03 |
| 14 | 16 | 4⅜ | 4⅜ | 104 | 100/150 | 356 | 406 | 111 | 111 | 47.27 | 0.69/1.03 |
| 16 | 17¼ | 4½ | 4½ | 143 | 100/150 | 406 | 438 | 114 | 114 | 64.86 | 0.69/1.03 |

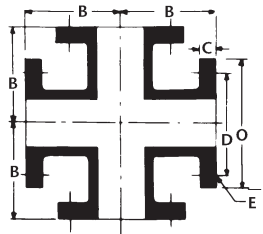

CROSS FLANGED⁽²⁾

| Nom Pipe Size | B | C | D | E | O | Nom Wgt. | Cyclic/ Steady Pressure | Nom Pipe Size | B | C | D | E | O | Nom Wgt. | Cyclic/ Steady Pressure |
|---------------|-----|-----|-----|--------------|-----|----------|-------------------------|---------------|-----|----|-----|--------------|-----|----------|-------------------------|
| In. | In. | In. | In. | In. | In. | Lbs. | psig | mm | mm | mm | mm | mm | mm | kg | MPa |
| 1 | 3½ | ¾ | 3⅝ | ⅝D-4 holes | 4¼ | 3.8 | 200/300 | 25 | 89 | 19 | 79 | 16D-4holes | 108 | 1.7 | 1.38/2.07 |
| 1½ | 4 | ¾ | 3⅝ | ⅝D-4 holes | 5 | 5.4 | 200/300 | 38 | 102 | 19 | 79 | 16D-4holes | 127 | 2.5 | 1.38/2.07 |
| 2 | 4½ | ¾ | 4¾ | ¾D-4 holes | 6 | 8.6 | 200/300 | 51 | 114 | 19 | 121 | 19D-4holes | 152 | 3.9 | 1.38/2.07 |
| 3 | 5½ | 1⅝ | 6 | ¾D-4 holes | 7½ | 15.1 | 125/190 | 76 | 140 | 35 | 152 | 19D-4holes | 191 | 6.8 | 0.86/1.31 |
| 4 | 6½ | 1⅝ | 7½ | ¾D-8 holes | 9 | 22.8 | 100/150 | 102 | 165 | 35 | 191 | 19D-8holes | 229 | 10.3 | 0.69/1.03 |
| 6 | 8 | 1½ | 9½ | ⅞D-8 holes | 11 | 34.9 | 100/150 | 152 | 203 | 38 | 241 | 22D-8holes | 279 | 15.8 | 0.69/1.03 |
| 8 | 9 | 1¾ | 11¾ | ⅞D-8 holes | 13½ | 61.2 | 100/150 | 203 | 229 | 44 | 298 | 22D-8holes | 343 | 27.8 | 0.69/1.03 |
| 10 | 11 | 2 | 14¼ | 1D-12 holes | 16 | 83.5 | 100/150 | 254 | 279 | 51 | 362 | 25D-12 holes | 406 | 37.9 | 0.69/1.03 |
| 12 | 12 | 2¼ | 17 | 1D-12 holes | 19 | 145 | 100/150 | 305 | 305 | 57 | 432 | 25D-12holes | 483 | 65.8 | 0.69/1.03 |
| 14 | 14 | 2½ | 18¾ | 1⅞D-12 holes | 20¾ | 224 | 100/150 | 356 | 356 | 64 | 476 | 29D-12holes | 527 | 102 | 0.69/1.03 |
| 16 | 15 | 2½ | 21¼ | 1⅞D-16 holes | 23¼ | 303 | 100/150 | 406 | 381 | 64 | 540 | 29D-16holes | 594 | 137 | 0.69/1.03 |

⁽¹⁾This is a nominal make-up dimension for drawing layout work only. Do not use for assembly dimensions.

⁽²⁾Flanges should be joined only to flat-faced flanges. See Smith Fibercast Installation Instructions for valve, torque, bolt, and gasket recommendations.

SADDLES (Parts are available in GREEN THREAD only.)



BELLED SIDE OUTLET

| Nom Size | A | B | C Angle | X ⁽¹⁾ W/GT Pipe | X ⁽¹⁾ W/RTII Pipe | Nom Wgt. | Cyclic/ Steady Pressure | Nom. Size | A | B | X ⁽¹⁾ W/GT Pipe | X ⁽¹⁾ W/RTII Pipe | Nom Wgt. | Cyclic/ Steady Pressure |
|---|--------------------------------|-----|---------|-------------------------------|-------------------------------|----------|-------------------------|-----------|-----|-----|----------------------------|------------------------------|----------|-------------------------|
| In. | In. | In. | Degree | In. | In. | Lbs. | psig | mm | mm | mm | mm | mm | kg | MPa |
| 2x1 | 2 ⁵ / ₈ | 4 | 180 | 1 | - | .6 | 300/450 | 51x25 | 73 | 102 | 25 | - | 0.27 | 2.07/3.10 |
| 2x1 ¹ / ₂ | 2 ⁷ / ₈ | 4 | 180 | 1 ³ / ₈ | - | .5 | 300/450 | 51x38 | 73 | 102 | 35 | - | 0.23 | 2.07/3.10 |
| 3x1 | 3 ¹ / ₂ | 6 | 180 | 1 | - | 1.5 | 200/300 | 76x25 | 89 | 152 | 25 | - | 0.68 | 1.38/2.07 |
| 3x1 ¹ / ₂ | 3 ¹ / ₂ | 6 | 180 | 1 ³ / ₈ | - | .9 | 200/300 | 76x38 | 89 | 152 | 35 | - | 0.41 | 1.38/2.07 |
| 3x2 | 4 | 6 | 180 | 1 ⁵ / ₈ | 1 ⁵ / ₈ | 1.4 | 200/300 | 76x51 | 102 | 152 | 41 | 35 | 0.64 | 1.38/2.07 |
| 4x1 | 4 | 6 | 180 | 1 | - | 1.4 | 150/225 | 102x25 | 102 | 152 | 25 | - | 0.64 | 1.03/1.55 |
| 4x1 ¹ / ₂ | 4 | 6 | 180 | 1 ³ / ₈ | - | 1.5 | 150/225 | 102x38 | 102 | 152 | 35 | - | 0.68 | 1.03/1.55 |
| 4x2 | 4 ¹ / ₂ | 6 | 180 | 1 ⁵ / ₈ | 1 ⁵ / ₈ | 1.5 | 150/225 | 102x51 | 114 | 152 | 41 | 35 | 0.68 | 1.03/1.55 |
| 4x3 | 5 ¹ / ₄ | 6 | 180 | 2 ¹ / ₈ | 1 ⁵ / ₈ | 1.6 | 150/225 | 102x76 | 133 | 152 | 54 | 41 | 0.73 | 1.03/1.55 |
| 6x1 | 5 | 6 | 120 | 1 | - | 1.4 | 150/225 | 152x25 | 127 | 152 | 25 | - | 0.64 | 1.03/1.55 |
| 6x1 ¹ / ₂ | 5 | 6 | 120 | 1 ³ / ₈ | - | 1.3 | 150/225 | 152x38 | 127 | 152 | 35 | - | 0.59 | 1.03/1.55 |
| 6x2 | 5 ¹ / ₂ | 6 | 120 | 1 ⁵ / ₈ | 1 ⁵ / ₈ | 1.5 | 150/225 | 152x51 | 140 | 152 | 41 | 35 | 0.68 | 1.03/1.55 |
| 6x3 | 6 ¹ / ₄ | 6 | 120 | 2 ¹ / ₈ | 1 ⁵ / ₈ | 1.6 | 150/225 | 152x76 | 159 | 152 | 54 | 41 | 0.73 | 1.03/1.55 |
| 6x4 | 6 ³ / ₈ | 8 | 140 | 2 | 1 ¹ / ₂ | 2.4 | 150/225 | 152x102 | 162 | 203 | 51 | 38 | 1.09 | 1.03/1.55 |
| 8x1 ⁽²⁾ | 7 ⁵ / ₈ | 9 | 120 | 1 | - | 3.1 | 150/225 | 203x25 | 181 | 229 | 25 | - | 1.41 | 1.03/1.55 |
| 8x1 ¹ / ₂ ⁽²⁾ | 7 ⁵ / ₈ | 9 | 120 | 1 ³ / ₈ | - | 2.8 | 150/225 | 203x38 | 181 | 229 | 35 | - | 1.27 | 1.03/1.55 |
| 8x2 | 7 ⁵ / ₈ | 9 | 120 | 1 ⁵ / ₈ | 1 ⁵ / ₈ | 2.7 | 150/225 | 203x51 | 181 | 229 | 41 | 35 | 1.22 | 1.03/1.55 |
| 8x3 | 8 | 14 | 180 | 2 ¹ / ₈ | 1 ⁵ / ₈ | 6 | 150/225 | 203x76 | 203 | 356 | 54 | 41 | 2.72 | 1.03/1.55 |
| 8x4 | 7 ³ / ₈ | 14 | 180 | 2 | 1 ¹ / ₂ | 6.1 | 150/225 | 203x102 | 187 | 356 | 51 | 38 | 2.77 | 1.03/1.55 |
| 8x6 | 9 ⁵ / ₈ | 14 | 180 | 2 ⁷ / ₈ | 2 ³ / ₈ | 7.7 | 125/190 | 203x152 | 244 | 356 | 73 | 60 | 3.49 | 0.86/1.31 |
| 10x1 ⁽²⁾ | 8 ⁵ / ₈ | 9 | 95 | 1 | - | 3.1 | 150/225 | 254x25 | 206 | 229 | 25 | - | 1.41 | 1.03/1.55 |
| 10x1 ¹ / ₂ ⁽²⁾ | 8 ⁵ / ₈ | 9 | 95 | 1 ³ / ₈ | - | 2.8 | 150/225 | 254x38 | 206 | 229 | 35 | - | 1.27 | 1.03/1.55 |
| 10x2 | 8 ⁵ / ₈ | 9 | 95 | 1 ⁵ / ₈ | 1 ³ / ₈ | 2.7 | 150/225 | 254x51 | 206 | 229 | 41 | 35 | 1.22 | 1.03/1.55 |
| 10x3 | 9 | 14 | 150 | 2 ¹ / ₈ | 1 ⁵ / ₈ | 6.1 | 150/225 | 254x76 | 229 | 356 | 54 | 41 | 2.77 | 1.03/1.55 |
| 10x4 | 8 ³ / ₈ | | 180 | 2 | 1 ¹ / ₂ | 8.4 | 150/225 | 254x102 | 213 | 425 | 51 | 38 | 3.81 | 1.03/1.55 |
| 10x6 | 10 ⁵ / ₈ | | 180 | 2 ⁷ / ₈ | 2 ³ / ₈ | 10 | 125/190 | 254x152 | 270 | 425 | 73 | 60 | 4.54 | 0.86/1.31 |
| 10x8 | 12 ¹ / ₈ | | 180 | 3 ³ / ₈ | 4 ³ / ₈ | 11.9 | 100/150 | 254x203 | 308 | 425 | 86 | 111 | 5.40 | 0.69/1.03 |
| 12x1 ⁽²⁾ | 9 ⁵ / ₈ | 10 | 90 | 1 | - | 3.6 | 150/225 | 305x25 | 232 | 254 | 25 | - | 1.63 | 1.03/1.55 |
| 12x1 ¹ / ₂ ⁽²⁾ | 9 ⁵ / ₈ | 10 | 90 | 1 ³ / ₈ | - | 3.3 | 150/225 | 305x38 | 232 | 254 | 35 | - | 1.50 | 1.03/1.55 |
| 12x2 | 9 ⁵ / ₈ | 10 | 90 | 1 ⁵ / ₈ | 1 ³ / ₈ | 3.2 | 150/225 | 305x51 | 232 | 254 | 41 | 35 | 1.45 | 1.03/1.55 |
| 12x3 | 10 | 14 | 125 | 2 ¹ / ₈ | 1 ⁵ / ₈ | 6.1 | 150/225 | 305x76 | 254 | 356 | 54 | 41 | 2.77 | 1.03/1.55 |
| 12x4 | 9 ³ / ₈ | 17 | 155 | 2 | 1 ¹ / ₂ | 8.6 | 150/225 | 305x102 | 238 | 432 | 51 | 38 | 3.90 | 1.03/1.55 |
| 12x6 | 11 ⁵ / ₈ | 21 | 180 | 2 ⁷ / ₈ | 2 ³ / ₈ | 13.5 | 150/225 | 305x152 | 296 | 533 | 73 | 60 | 6.12 | 1.03/1.55 |
| 12x8 | 13 ¹ / ₈ | 21 | 180 | 3 ³ / ₈ | 4 ³ / ₈ | 15.3 | 125/190 | 305x203 | 333 | 533 | 86 | 111 | 6.94 | 0.86/1.31 |
| 12x10 | 13 | 21 | 180 | 3 ³ / ₈ | 4 ³ / ₈ | 22 | 100/150 | 305x254 | 330 | 533 | 98 | 105 | 9.98 | 0.69/1.03 |

⁽¹⁾This is a nominal make-up dimension for drawing layout work only. Do not use for assembly directions.

⁽²⁾Saddle is manufactured by bonding a reducer bushing into a saddle with a 2" outlet.

SADDLES, Continued (Parts are available in GREEN THREAD only.)

| Nom Size | A | B | C Angle | X ⁽¹⁾ W/GT Pipe | X ⁽¹⁾ W/RTII Pipe | Nom Wgt. | Cyclic/ Steady Pressure | Nom Size | A | B | X ⁽¹⁾ W/GT Pipe | X ⁽¹⁾ W/RTII Pipe | Nom Wgt. | Cyclic/ Steady Pressure |
|----------------------|-----|-----|---------|----------------------------|------------------------------|----------|-------------------------|----------|-----|-----|----------------------------|------------------------------|----------|-------------------------|
| In. | In. | In. | Degree | In. | In. | Lbs. | psig | mm | mm | mm | mm | mm | kg | MPa |
| 14x1 ⁽²⁾ | 10 | 12 | 95 | 1 | - | 4.7 | 150/225 | 356x25 | 254 | 305 | 25 | - | 2.13 | 1.03/1.55 |
| 14x1½ ⁽²⁾ | 10 | 12 | 95 | 1¾ | - | 4.4 | 150/225 | 356x38 | 254 | 305 | 35 | - | 2.00 | 1.03/1.55 |
| 14x2 | 10 | 12 | 95 | 1¾ | 1¾ | 4.3 | 150/225 | 356x51 | 254 | 305 | 41 | 35 | 1.95 | 1.03/1.55 |
| 14x3 | 10¾ | 15 | 120 | 2¼ | 1¾ | 6.9 | 150/225 | 356x76 | 276 | 381 | 54 | 41 | 3.13 | 1.03/1.55 |
| 14x4 | 10¼ | 17 | 135 | 2 | 1½ | 8.4 | 150/225 | 356x102 | 260 | 432 | 51 | 38 | 3.81 | 1.03/1.55 |
| 14x6 | 12¾ | 21 | 165 | 2¾ | 2¾ | 12.2 | 150/225 | 356x152 | 321 | 533 | 73 | 60 | 5.53 | 1.03/1.55 |
| 14x8 | 14 | 21 | 165 | 3¾ | 4¾ | 15.9 | 150/225 | 356x203 | 356 | 533 | 86 | 111 | 7.21 | 1.03/1.55 |
| 14x10 | 14 | 26 | 180 | 3¾ | 4¾ | 28.4 | 100/150 | 356x254 | 356 | 660 | 98 | 105 | 12.88 | 0.69/1.03 |
| 14x12 | 14¾ | 26 | 180 | 4 | 4¼ | 30.1 | 100/150 | 356x305 | 365 | 660 | 102 | 108 | 13.65 | 0.69/1.03 |
| 16x1 ⁽²⁾ | 11 | 13 | 90 | 1 | - | 5.4 | 150/225 | 406x25 | 279 | 330 | 25 | - | 2.45 | 1.03/1.55 |
| 16x1½ ⁽²⁾ | 11 | 13 | 90 | 1¾ | - | 5.1 | 150/225 | 406x38 | 279 | 330 | 35 | - | 2.31 | 1.03/1.55 |
| 16x2 | 11 | 13 | 90 | 1¾ | 1¾ | 5 | 150/225 | 406x51 | 279 | 330 | 41 | 35 | 2.27 | 1.03/1.55 |
| 16x3 | 11¾ | 15 | 105 | 2¼ | 1¾ | 6.9 | 150/225 | 406x76 | 302 | 381 | 54 | 41 | 3.13 | 1.03/1.55 |
| 16x4 | 11¼ | 17 | 120 | 2 | 1½ | 8.6 | 150/225 | 406x102 | 286 | 432 | 51 | 38 | 3.90 | 1.03/1.55 |
| 16x6 | 13¾ | 21 | 145 | 2¾ | 2¾ | 14.2 | 150/225 | 406x152 | 346 | 533 | 73 | 60 | 6.44 | 1.03/1.55 |
| 16x8 | 15 | 26 | 180 | 3¾ | 4¾ | 21.9 | 150/225 | 406x203 | 381 | 660 | 86 | 111 | 9.93 | 1.03/1.55 |
| 16x10 | 15 | 26 | 180 | 3¾ | 4¾ | 31 | 150/225 | 406x254 | 381 | 660 | 98 | 105 | 14.06 | 1.03/1.55 |
| 16x12 | 15¾ | 26 | 180 | 4 | 4¼ | 32.6 | 100/150 | 406x305 | 391 | 660 | 102 | 108 | 14.77 | 0.69/1.03 |
| 16x14 | 14¾ | 26 | 180 | 3¾ | 3¾ | 30.6 | 100/150 | 406x356 | 359 | 660 | 92 | 92 | 13.88 | 0.69/1.03 |

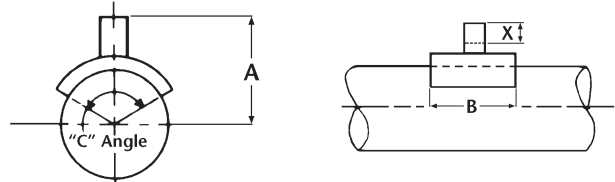

THREADED SIDE OUTLET NPT INTERNAL THREADS

| Nom. Size | A | B | C Angle | Nom. Wgt. | Cyclic/ Steady Pressure | Nom. Size | A | B | Nom. Wgt. | Cyclic/ Steady Pressure |
|-----------|-----|-----|---------|-----------|-------------------------|-----------|-----|-----|-----------|-------------------------|
| In. | In. | In. | Degree | Lbs. | psig | mm | mm | mm | kg | MPa |
| 2x1 | 2¾ | 4 | 180 | .6 | 300/450 | 51x25 | 73 | 102 | 0.27 | 2.07/3.10 |
| 2x1¼ | 2¾ | 4 | 180 | .6 | 300/450 | 51x32 | 73 | 102 | 0.27 | 2.07/3.10 |
| 2x1½ | 2¾ | 4 | 180 | .5 | 300/450 | 51x38 | 73 | 102 | 0.23 | 2.07/3.10 |
| 3x1 | 3½ | 6 | 180 | 1.1 | 200/300 | 76x25 | 89 | 152 | 0.50 | 1.38/2.07 |
| 3x1¼ | 3½ | 6 | 180 | 1.0 | 200/300 | 76x32 | 89 | 152 | 0.45 | 1.38/2.07 |
| 3x1½ | 3½ | 6 | 180 | 1.0 | 200/300 | 76x38 | 89 | 152 | 0.45 | 1.38/2.07 |
| 4x1 | 4 | 6 | 180 | 1.6 | 150/225 | 102x25 | 102 | 152 | 0.73 | 1.03/1.55 |
| 4x1¼ | 4 | 6 | 180 | 1.5 | 150/225 | 102x32 | 102 | 152 | 0.68 | 1.03/1.55 |
| 4x1½ | 4 | 6 | 180 | 1.4 | 150/225 | 102x38 | 102 | 152 | 0.64 | 1.03/1.55 |
| 6x1 | 5 | 6 | 120 | 1.5 | 150/225 | 152x25 | 127 | 152 | 0.68 | 1.03/1.55 |
| 6x1¼ | 5 | 6 | 120 | 1.4 | 150/225 | 152x32 | 127 | 152 | 0.64 | 1.03/1.55 |
| 6x1½ | 5 | 6 | 120 | 1.5 | 150/225 | 152x38 | 127 | 152 | 0.68 | 1.03/1.55 |
| 8x1 | 7¾ | 9 | 120 | 3.1 | 150/225 | 203x25 | 181 | 229 | 1.41 | 1.03/1.55 |
| 10x1 | 8¾ | 9 | 95 | 3.1 | 150/225 | 254x25 | 206 | 229 | 1.41 | 1.03/1.55 |
| 12x1 | 9¾ | 10 | 90 | 3.6 | 150/225 | 305x25 | 232 | 254 | 1.63 | 1.03/1.55 |
| 14x1 | 10 | 12 | 95 | 4.7 | 150/225 | 356x25 | 254 | 305 | 2.13 | 1.03/1.55 |
| 16x1 | 11 | 13 | 90 | 5.4 | 150/225 | 406x25 | 279 | 330 | 2.45 | 1.03/1.55 |